



TECH BOOK

CABLE BOX

V4.1

INDEX

1	Intro System
4	<i>A-Box</i>
6	<i>S-Box</i>
8	<i>C-Box</i>
10	<i>M-Box</i>
12	Model Chart
13	Feature Comparison
14	Installation Guide
16	Stem-Bar Options
36	Headset Tech Drawings

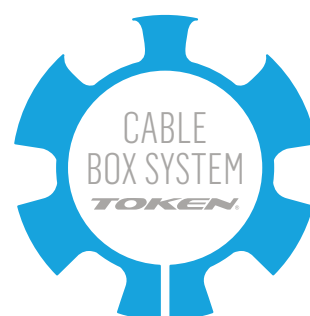

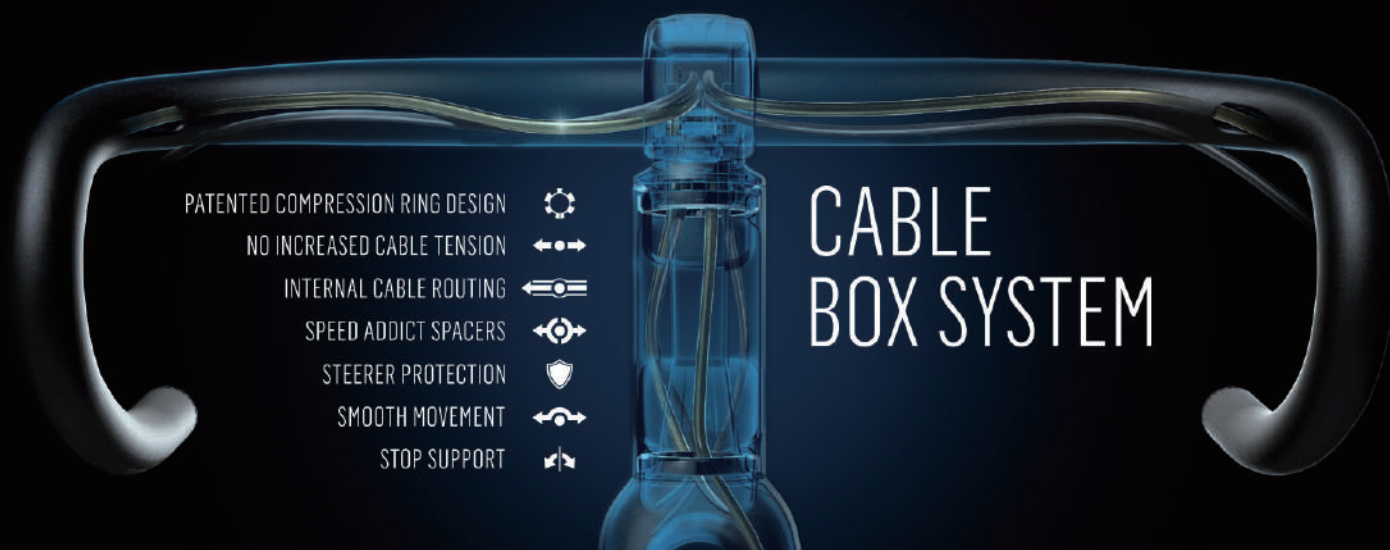

INTRO

Token has created the most streamlined aero cable routing solution. The Token Cable Box System's versatile construction allows for both fully integrated and semi-integrated cable routing in a design that's been engineered for ease-of-use.

The adaptable design was conceived to be compatible with a wide variety of handlebar choices, while ergonomic comfort and supreme aesthetics join extreme engineering to result in the ultimate streamlined aero performance.

The Token Cable Box System is an aero integrated cable routing system that comes in five different versions:

A-Box: Fully integrated cable routing for the best **A**erodynamic, swift rotation and ultra smooth shifting performance.

S-Box: **S**emi -integrated cable routing system with individual cable seals for 4mm, 5mm cables, Shimano Di2 cable or simply plug.

C-Box: Semi-integrated cable routing system with **c**able cover designed. The adjustable cover permits routing without removing the stem so that cockpit installations and upgrades can be done effortlessly.

M-Box: Most secure solution for **M**TB & eMTB with up-to 6 Cables/ Wires.
(MB-BOX: w/Rotation Block Set)

TOKEN

CABLE BOX SYSTEM
(PATENTED)



A-BOX

AERO Integrated Cable Routing System



B-BOX

Semi-Integrated Cable Routing System
with Rotation Block



S-BOX

Semi-Integrated Cable Routing System



E-BOX

100% for E-Bike. 100% customizable.
Patented Half Aisles for Electrical Connectors
to go through with good water seal function.



C-BOX

Semi-Integrated Cable Routing System
with Cable Cover

A-Box Headset

AERO Integrated Cable Routing System

Frame:

IS52 / IS52, 1.5" Integrated Head Tube

ZS56 / ZS56, 1.5" Internal Head Tube

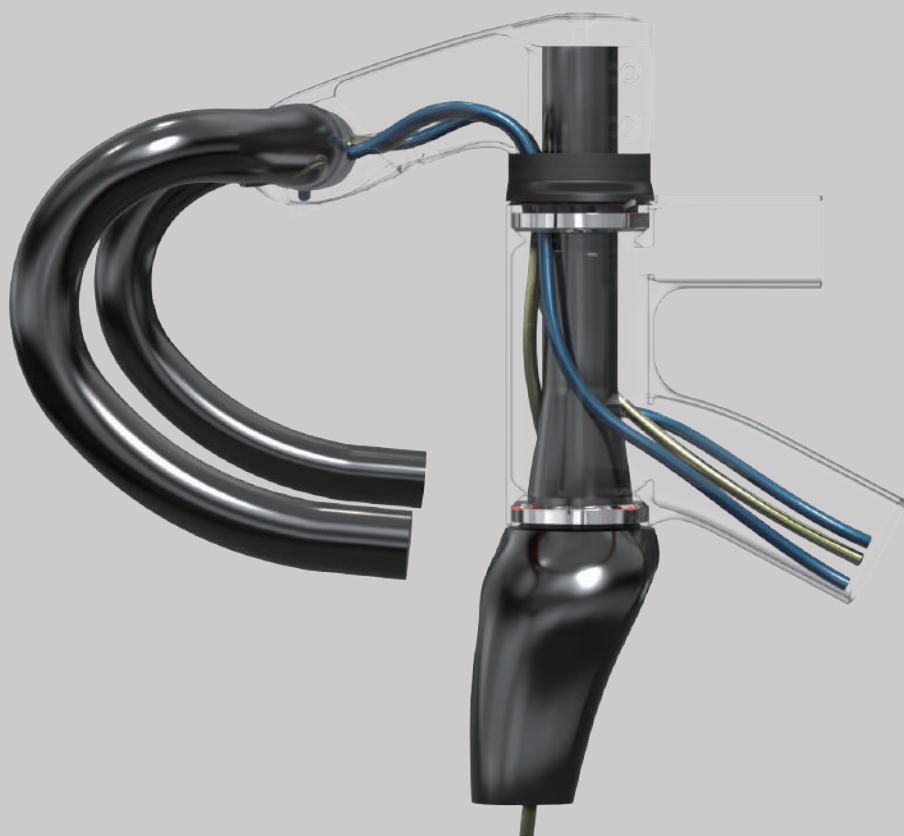

Speed Addict Spacer
5mm / 10mm
by Order



Top Cover



Top Cover Seal



Micro Spacer



Star Compression Ring



Double Seals
Premium Bearing
45°



Upper / Lower Cup
ZS or EC type
by Order

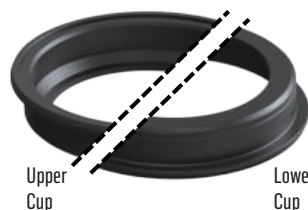

Upper
Cup

Lower
Cup

Double Seals
Premium Bearing
45° or 36°
by Order



Crown Race
45° or 36°
by Order





Stem: Integrated Cable Routing with Hole in the bottom
Bar: Integrated Cable Routing with Hole at Bar Center
Fork: Molded with Hole for Front Braking Cable

A-BOX



ORROBIKES
VENTURI STC

S-Box Headset

Semi-Integrated Cable Routing System

Frame:

IS52 / IS52, 1.5" Integrated Head Tube

ZS56 / ZS56, 1.5" Internal Head Tube

ZS56 / ZS66, 1.5"-1.8" Internal Head Tube

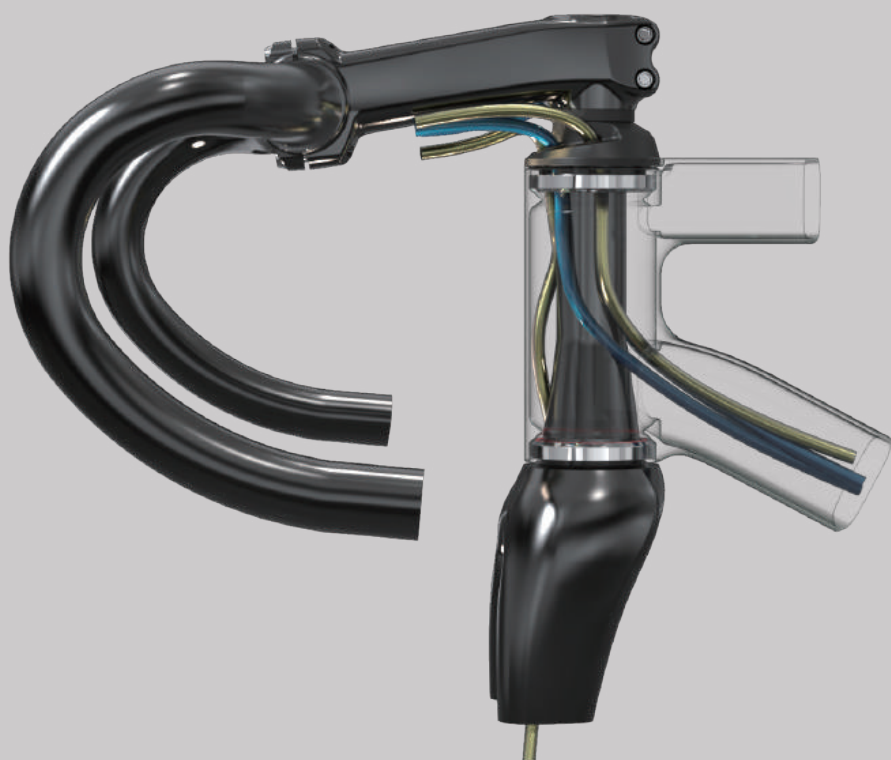

Cable Seals
by Order



Headset Top Cover



Top Cover Seal



Micro Spacer



Star Compression Ring



Double Seals
Premium Bearing
45°



Upper / Lower Cup
ZS or EC type
by Order



Double Seals
Premium Bearing
45° or 36°
by Order



Crown Race
45° or 36°
by Order



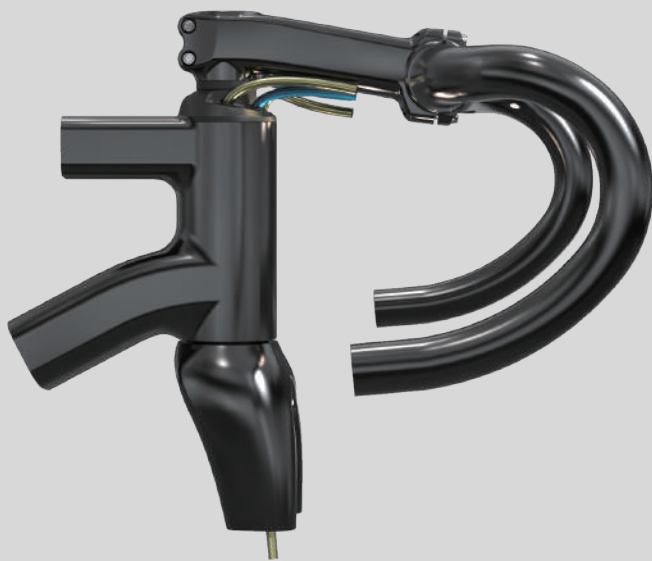

Bar & Stem: Standard

Fork: Molded with Hole for Front Braking Cable

Excellent Water Seal Performance

Water Seals Inserted into the Cable Holes

3 types of seals for 4mm, 5mm cables or just plug by order

S-BOX



FARA CYCLING
F/AR



Cable Seal Option for Wide Compatibiliy

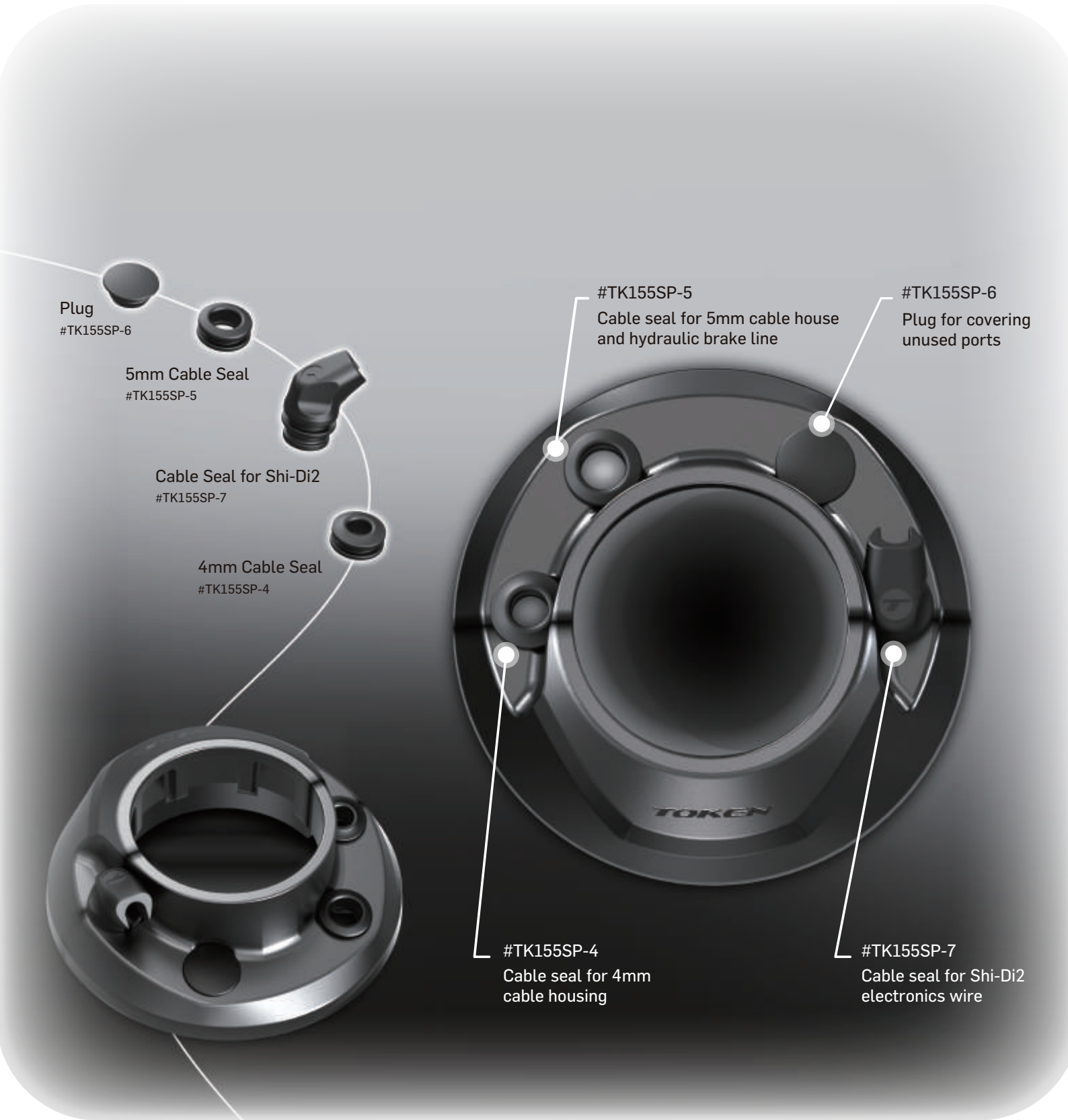

Cable Seal Option for Wide Compatibiliy

TK155SP-5
5mm Cable Seal

TK155SP-4
4mm Cable Seal

TK155SP-CHHC

TK155SP-5
5mm Cable Seal

TK155SP-4
4mm Cable Seal

TK155SP-5
5mm Cable Seal

TK155SP-6
Plug

TK155SP-OHHO

TK155SP-5
5mm Cable Seal

TK155SP-6
Plug

TK155SP-5
5mm Cable Seal

TK155SP-6
Plug

TK155SP-OHHC

TK155SP-5
5mm Cable Seal

TK155SP-4
4mm Cable Seal

TK155SP-5
5mm Cable Seal

TK155SP-4
4mm Cable Seal

TK155SP-CHOC

TK155SP-5
5mm Cable Seal

TK155SP-6
Plug

TK155SP-4
4mm Cable Seal

Cable seal for 5mm cable house
and hydraulic brake line

TK155SP-5

TK155SP-6
Plug for covering unused ports

TK155SP-OHHD

Cable seal for 5mm cable house
and hydraulic brake line

TK155SP-5

TK155SP-7
Cable seal for Shi-Di2
electronics wire

C-Box Headset

Semi-Integrated Cable Routing System
with **Cable Cover**

Frame:

IS52 / IS52, 1.5" Integrated Head Tube

ZS56 / ZS56, 1.5" Internal Head Tube



Cable Cover



Speed Addict Spacer
5mm / 10mm
by Order



Top Cover



Top Cover Seal



Micro Spacer



Star Compression Ring



Double Seals
Premium Bearing
45°

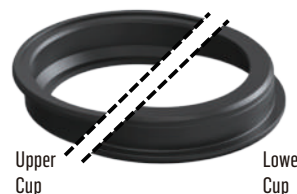

Upper / Lower Cup
ZS or EC type
by Order



Upper
Cup

Lower
Cup



Double Seals
Premium Bearing
45° or 36°
by Order



Crown Race
45° or 36°
by Order



Stem: Unique design with compatible shape to Cable Cover
Cable Cover: Unique design with compatible shape to Stem
Bar: Standard
Fork: Molded with Hole for Front Braking Cable

C-BOX



CEEPO
RINDO

M-BOX

Cable Box for **M**TB & e**M**TB

Frame:

ZS56 / ZS56, 1.5" Internal Head Tube

ZS56 / ZS66, 1.8" Internal Head Tube

Head Tube Size:

Top TID. : Dia.56mm

Bottom BID: Dia. 56mm (1.5") or 66mm (1.8")

Model:

TK3566 (ZS56 / ZS56)

TK3586 (ZS56 / ZS66)

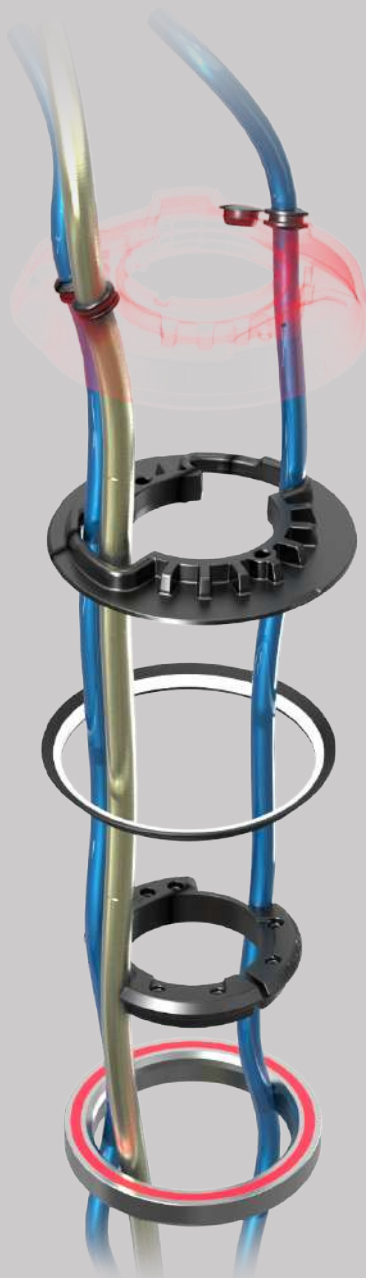

Top Cover Seal



Star Compression Ring



Double Seals
Premium Bearing 45°



Upper / Lower Cup
by order



Double Seals
Premium Bearing 45°



Crown Race 45°





Bar, Stem & Fork: Standard

MB-BOX (w/Rotation Block Set)

Crown Race Secure Design:

Crown is designed with split and locking bolt to tighten and secure.

Unique locking bolt design for easily tightening without self-loosing.

Easily to install & removal without damage the fork.

Patent Pending.



Block Set Intro

MB-BOX

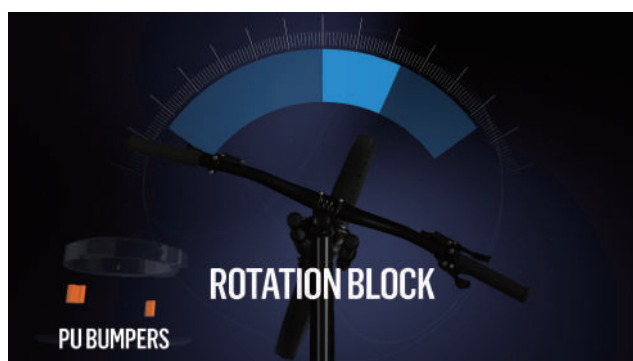

H/Bar Spinning Angle 124 deg

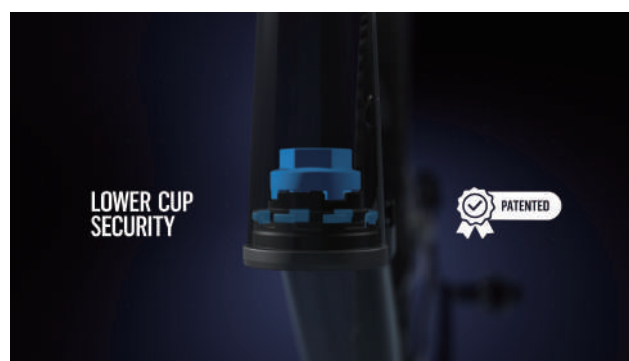

Double Security Construction



Cable Seal Instruction

1.

4mm Cable Housings
(Shifting / Dropper Post)



2.

5mm Brake Hose



3.

Electric Wires
Feeding & Connecting



Cable Seal Option for Wide Compatibiliy

TK155SP-5

5mm Cable Seal

TK155SP-4

4mm Cable Seal



TK355P-CHHC

TK155SP-5

5mm Cable Seal

TK155SP-4

4mm Cable Seal

TK155SP-5

5mm Cable Seal

TK155SP-6

Plug



TK355P-OHHO

TK155SP-5

5mm Cable Seal

TK155SP-6

Plug

TK155SP-5

5mm Cable Seal

TK155SP-6

Plug



TK355P-OHHC

TK155SP-5

5mm Cable Seal

TK155SP-4

4mm Cable Seal

TK155SP-5

5mm Cable Seal

TK155SP-4

4mm Cable Seal



TK355P-CHOC

TK155SP-6

Plug

TK155SP-4

4mm Cable Seal

Cable seal for 5mm cable house
and hydraulic brake line

TK155SP-5

TK155SP-6

Plug for covering unused ports



TK355P-OHHD

Cable seal for 5mm cable house
and hydraulic brake line

TK155SP-5

TK155SP-7

Cable seal for Shi-Di2
electronics wire

Cable Box Model Chart

Road Bike		A-BOX / C-BOX		S-BOX	
		Standard Top Cover	Top Cover For ZOOM Stem	Standard Top Cover	Top Cover For ZOOM Stem
Integrated Headset (IS52 / 28.6 IS52 / 40)	<input checked="" type="checkbox"/> Top Cover; <input checked="" type="checkbox"/> Crown Race 45° Bottom Bearing	TK155 TK155P	TK155ZM	TK155SP	TK155SPH
	<input checked="" type="checkbox"/> Top Cover; <input checked="" type="checkbox"/> Crown Race 36° Bottom Bearing	TK155-36 TK155P-36	TK155ZM-36	TK155SP-36	TK155SPH-36
	<input checked="" type="checkbox"/> Top Cover; <input checked="" type="checkbox"/> Crown Race 45° Bottom Bearing	TK1556 TK1556P	TK1556ZM	TK1556SP	TK1556SPH
	<input checked="" type="checkbox"/> Top Cover; <input checked="" type="checkbox"/> Crown Race 45° Bottom Bearing	TK155-KIT			
	<input checked="" type="checkbox"/> Top Cover; <input checked="" type="checkbox"/> Crown Race 36° Bottom Bearing	TK155-36-KIT			
	<input checked="" type="checkbox"/> Top Cover; <input checked="" type="checkbox"/> Crown Race 45° Bottom Bearing	TK1556-KIT			
External Cup	EC44 / 28.6 EC44 / 40	TK1536 TK1536P	TK1536ZM	TK1536SP	TK1536SPH
External Cup	EC44 / 28.6 ZS56 / 40	TK1537 TK1537P	TK1537ZM	TK1537SP	TK1537SPH

MTB & eMTB		M-BOX	MB-BOX
		Standard w/o Rotation Block	w/Rotation Block at Bottom Cup
Zero-Stack Headset	ZS56 / 28.6 ZS56 / 40	TK3566	TK3566B
	ZS56 / 28.6 ZS66 / 46	TK3586	TK3586B

Feature Comparison

	TOKEN					Remark
	A-Box	S-Box	M-Box	C-Box	E-Box	
Cable Integration	★★★	★	★	★★	★	★★★: Fully Integrated Cable Routing ★★: With Cable Cover ★: Without Cable Cover
Rotation & Shifting Performance	★★★	★★★	★★★	★★★	★★★	★★★: Cable Over-Bending Prevention & Easy Cable Separation ★★: One of above ★: Not Enough Cable Radius & No Cable Segment
Water Resitance	★★★ (All 3 Seals)	★★★ (All 3 Seals)	★★★ (All 3 Seals)	★★ (Top Cover Seal & Double Bearing Seals)	★★★ (All 3 Seals)	★★★: Cable Seal, Top Cover & Double Bearing Seals ★★: 2 of Cable Seal, Top Cover & Double Bearing Seals ★: 1 of Cable Seal, Top Cover & Double Bearing Seals
Impact Resistance	★★	★★	★★★	★★	★★	★★★: Sufficient for MTB & eMTB ★★: Sufficient for Road with Stop Support ★: No Stop Support
Stack Height	★★★ (9mm)	★★ (19mm)	★★ (13.5mm)	★ (24mm)	★ (23.8mm)	★★★: <10mm ★★: 10~20mm ★: >20mm (Incl. Cable Cover)
Cable Number & Size Flexibility	★	★	★★★ (*1)	★	★★★ (*2)	★★★: Work with Electronic Cable w/Connector *1: Up to 6 Cables Incl. 4 Cable Housings. *2: Up to 8 Cables Incl. 6 Cable Housings. ★★: 5 Cables ★: 4 Cables

Cable Box Installation Guide

2021 - Sep

Step1.

Assemble the headset, stem, spacer and fork to the frame, note that the 45° chamfer on the bearing outer race should be placed toward the headtube.

Maximum spacer stacking height is 40mm.

Mark the top of the stem on the steerer, then mark a second line 3mm below it – this is the cutting line for later.

Step2.

Remove the fork from the frame and cut the steerer tube to the marked length.

Clean up any residual burr on the steerer tube.

Step3.

Feed the front brake line into the exit hole on the fork leg and route it through the fork.

Pull the brake line from the other end until the caliper end reach its final position.

The fork is ready for now, but do not assemble it back to the frame yet.

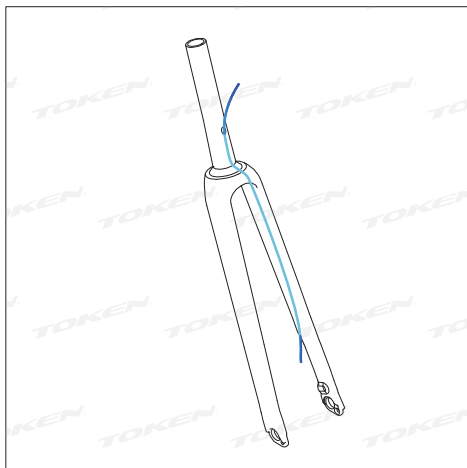

Step4.

Feed the shifting cable housings from the exit holes (near where the derailleurs attached to the frame) into the frame, route them through the down tube, and then exit from the top of the head tube.

Repeat the same process for the rear brake line.

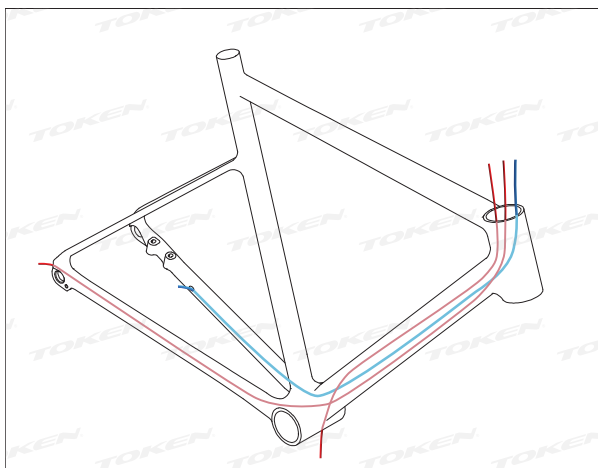

Step5.

Pull the housings / brake line from the headtube until the other end reach their final position (attach to the derailleurs / caliper, or cable guide).

Step6.

Insert the fork into the frame with the lower headset bearing assembled.

Then, mark the top of the headtube on all shifting cable housing and brake lines.

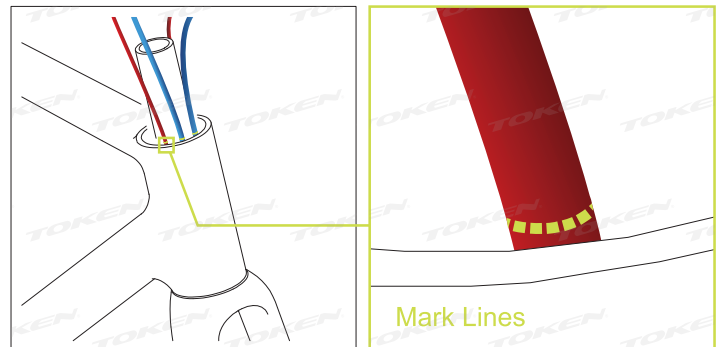

Step7.

Add "cockpit length" to complete the length measurement and mark it on each of the housings / brake lines – this is the cutting mark.

Cockpit length includes the following two parts (a+b) -

- Stem length
- Extra housing length needed to complete routing as shown in the chart below.

Road HB Width (C-to-C measured from shifter clamping area)	36cm	38cm	40cm	42cm	44cm
Extra Housing Length	32cm	33cm	34cm	35cm	36cm

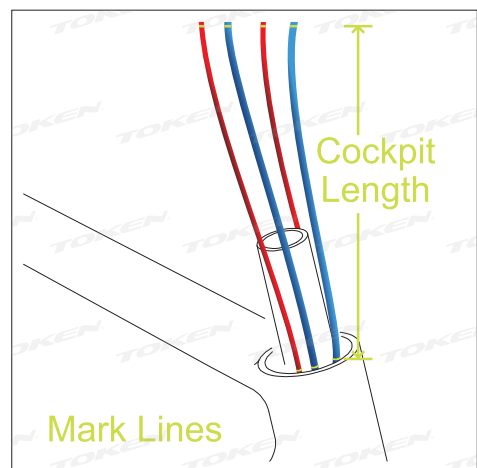

Step8.

Route the shifting cable housings and rear brake lines through one headset bearing and the headset top cover (with a water seal on it).

Each cable hole on the headset top cover holds one shifting housing (4mm) and one brake line (5mm).

Starting from the far left, they should be arranged as: rear shifting, rear brake, front brake and front shifting.

Shifting housings are placed at outer left and outer right to avoid tight turns which could degrade shifting performance.

Make sure all housings / brake line pass through headset top cover and the bearing!

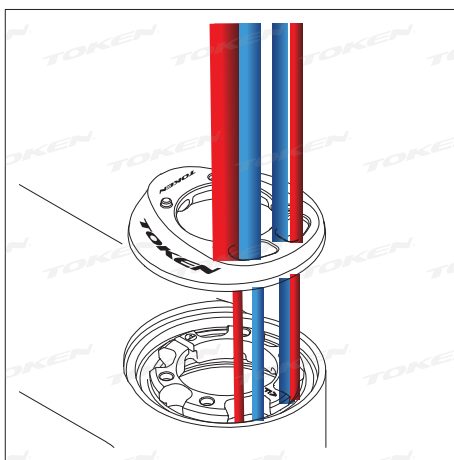

Step9.

Install the compression ring of the headset.

The compression ring should be placed between the headset top cover and the upper bearing.

Note that the "F mark" on it should be placed towards the front of the bike and all housings should be placed into the correct recess correspond to the two holes of the top cover.

When passing the steerer tube through the headtube, housings hold by the left hole of the headset top cover should be kept on the same (left) side of the steerer tube, and vice versa.

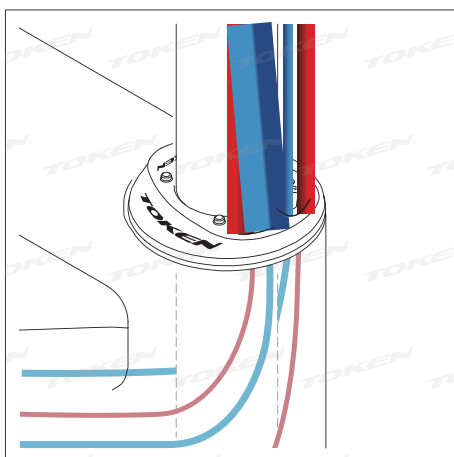

Step10.

Route the cable housings and brake lines through the stem and the handlebar.

Shifting housings / brake lines should be arranged as two groups when entering the center hole of the handlebar – upper group and lower group.

Each group should contain one shifting housing and one brake line, and should be connected to the same shifter later.

Some stems and handlebars have sharp edge around the cable holes.

Be careful when routing housings / brake lines through them.

Using cable routing tool kit such as Parktool IR-1 could make the task easier.

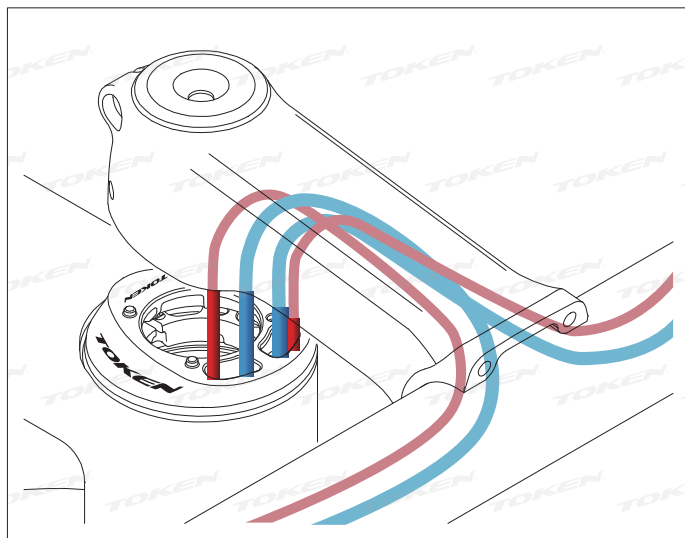

Step11.

Complete the installation of the headset, handlebar, stem and spacers.

A headset expander is usually needed here. Turn the handlebar left and right a few times to check if there's any restriction caused by housings / brake lines,

Step12.

Install the shifters to the preferred position on the handlebar, then check carefully if the cutting marks on each of the housings / brake lines is valid. Modify the position of the cutting mark slightly if needed.

Step13.

When all is checked and set, cut the shifting housings and brake lines, then move on to the installation and adjustment of derailleurs and brakes.

Installation Video for Cable Box.



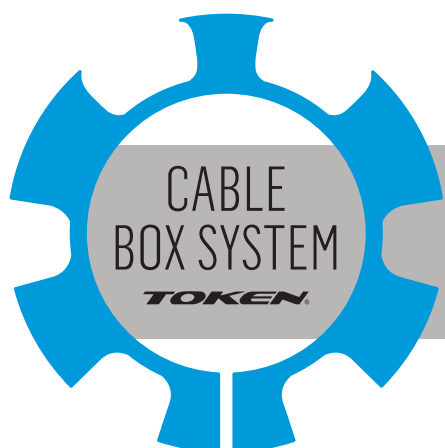

Stem - Bar Options

BLKTEC

PROFILE DESIGN 

CONTROL
TECH

 ***PROMAX***

MJCYCLE
Technically Beyond Amazing

TranzX
inspiring your ride

 **PARDUS**

 **zoom**
Precision Steering Components

BLK7EC**TOKEN®**

AERO Integrated Cable Routing System

Full Integrated Handle Bar

Model: R8

Hood-to-hood: 405mm

Drop-to-drop: 429mm

Bar Size (C-C): 400, 420, 440mm

Material: Carbon

Colour: Black

A-BOX

IS52/28.6 | IS52/40

Head Tube Size:

Top TIDxTD: Dia.52x8.7mm

Bottom BIDxBD: Dia.52x7mm

Model:

TK155 w/Carbon Top Cover

TK155P w/Composite Top Cover



Speed Addict Spacer
5mm / 10mm
by Order



Top Cover



Top Cover Seal



Micro Spacer
0.25mm (PAT.)



Star Compression Ring (PAT.)



Double Seals
Premium Bearing 45°



Double Seals
Premium Bearing
45° or 36° by Order



Crown Race 45° or 36°
by Order



Cable Box Intro



Cable Box Installation Info

BLK7EC**TOKEN®**

AERO Integrated Cable Routing System

Stem

Model: M6

Stem Weight: 127g (90mm), 132g (100mm), 137g (110mm)

Stem Bolt Material: Titanium

Stem Length: 90, 100, 110, 120, 130mm

Angle: -10°

Material: Carbon

Handle Bar

Model: R1

Bar Weight: 210g (420mm)

Bar Size (C-C): 380, 400, 420, 440mm

Bar Drop: 130.5mm

Bar Reach: 68.6mm

Material: Carbon

A-BOX

IS52/28.6 | IS52/40

Head Tube Size:

Top TIDxTD: Dia.52x8.7mm

Bottom BIDxBD: Dia.52x7mm

Model:

TK155 w/Carbon Top Cover

TK155P w/Composite Top Cover

Speed Addict Spacer
5mm / 10mm
by Order

Top Cover

Top Cover Seal

Micro Spacer
0.25mm (PAT.)

Star Compression Ring (PAT.)

Double Seals
Premium Bearing 45°

Double Seals
Premium Bearing
45° or 36° by Order

Crown Race 45° or 36°
by Order



Cable Box Intro



Cable Box Installation Info

CONTROL TECH



TOKEN®

Semi-Integrated Cable Routing System with Cable Cover

Stem

Model: RAS-114

Stem Weight: 217g (100mm)

Stem Bolt Material: SCM 435

Stem Length: 80, 90, 100, 110, 120mm

Angle: -8°

Material: Alloy

Cable cover, Split spacer 5mm x 1, 10mm x 2
and Headset top cap included

Handle Bar

Model: RA-527

Bar Drop: 125mm

Bar Reach: 75mm

Bar Size (C-C): 380, 400, 420, 440mm

Outward Bend 4°

Material: Alloy

Colour: Black

C-BOX (KIT)

IS52/28.6 | IS52/40

Head Tube Size:

Top TIDxTD: Dia.52x8.7mm

Bottom BIDxBD: Dia.52x7mm

Model:

TK155-KIT



Cable Box Intro



Cable Box Installation Info



TOKEN®

AERO Integrated Cable Routing System

Stem

Model: RAS-116

Stem Weight: 198g (100mm)

Stem Bolt Material: SCM 435

Stem Length: 80, 90, 100, 110, 120, 130mm

Angle: -8°

Material: Alloy

Split spacer 5mm x 1, 10mm x2 and Headset top cap included

Handle Bar

Model: RA-531

Bar Drop: 125mm

Bar Reach: 78mm

Bar Size (C-C): 380, 400, 420, 440mm

Material: Alloy

Colour: Black

A-BOX (KIT)

IS52/28.6 | IS52/40

Head Tube Size:

Top TIDxTD: Dia.52x8.7mm

Bottom BIDxBD: Dia.52x7mm

Model:

TK155-KIT



Top Cover Seal

Micro Spacer
0.25mm (PAT.)

Star Compression Ring (PAT.)

Double Seals
Premium Bearing 45°

Double Seals
Premium Bearing
45° or 36° by Order

Crown Race 45° or 36°
by Order



Cable Box Intro



Cable Box Installation Info

AERO Integrated Cable Routing System

Stem

Model: TB-099IN

Stem Length: 70 ~ 120mm

Angle: -8°

Material: Alloy

Colour: Black

Model: TB-099H-IN

With front cap holder

for Supernova Mini 2 light

Handlebar

Model: RH30S

Bar Drop: 131mm

Bar Reach: 71mm

Bar Size (C-C):

380, 400, 420, 440mm

Material: Alloy

Colour: Black

A-BOX

IS52/28.6 | IS52/40

Head Tube Size:

Top TIDxTD: Dia.52x8.7mm

Bottom BIDxBD: Dia.52x7mm

Model:

TK155 w/Carbon Top Cover

TK155P w/Composite Top Cover

Stem Model: TB-099IN

Speed Addict Spacer
5mm / 10mm
by Order



Front cap holder
for Supernova Mini 2 light



Cable Box Intro



Cable Box Installation Info

**TOKEN®**

AERO Integrated Cable Routing System

Full Integrated Handle Bar

Model: PD-HB-30

Reach: 76.2mm

Drop: 128.5mm

Stem angle: -3°

Bar Size (C-C):

400L: 95L, 110L

420L: 95L, 110L, 120L, 135L

440L: 95L, 110L, 120L, 135L

Material: Carbon

Colour: Matte Black

A-BOX

IS52/28.6 | IS52/40

Head Tube Size:

Top TIDxTD: Dia.52x8.7mm

Bottom BIDxBD: Dia.52x7mm

Model:

TK155 w/Carbon Top Cover

TK155P w/Composite Top Cover

Speed Addict Spacer
5mm / 10mm
by Order

Top Cover

Top Cover Seal

Micro Spacer
0.25mm (PAT.)

Star Compression Ring (PAT.)

Double Seals
Premium Bearing 45°

Double Seals
Premium Bearing
45° or 36° by Order

Crown Race 45° or 36°
by Order



Cable Box Intro



Cable Box Installation Info

**TOKEN®**

AERO Integrated Cable Routing System

Full Integrated Handle Bar

Model: PD-HB-48

Reach: 75mm

Drop: 124mm

Stem angle: -7°

Bar Size (C-C):

420L: 70L, 90L, 100L

440L: 100L, 110L

Material: Carbon

Colour: Matte Black

A-BOX

IS52/28.6 | IS52/40

Head Tube Size:

Top TIDxTD: Dia.52x8.7mm

Bottom BIDxBD: Dia.52x7mm

Model:

TK155 w/Carbon Top Cover

TK155P w/Composite Top Cover

Speed Addict Spacer
5mm / 10mm
by Order

Top Cover

Top Cover Seal

Micro Spacer
0.25mm (PAT.)

Star Compression Ring (PAT.)

Double Seals
Premium Bearing 45°

Double Seals
Premium Bearing
45° or 36° by Order

Crown Race 45° or 36°
by Order



Cable Box Intro



Cable Box Installation Info

**TOKEN®**

AERO Integrated Cable Routing System

Full Integrated Handle Bar

Model: PD-HB-53

Reach: 58mm

Drop: 129mm

Stem angle: -6°

Stem length: 80L, 90L, 100L, 110L, 120L, 130L

Bar size (c-c): 380L, 400L, 420L, 440L

Material: Carbon

Colour: Black

A-BOX

IS52/28.6 | IS52/40

Head Tube Size:

Top TIDxTD: Dia.52x8.7mm

Bottom BIDxBD: Dia.52x7mm

Model:

TK155 w/Carbon Top Cover

TK155P w/Composite Top Cover

Speed Addict Spacer
5mm / 10mm
by Order

Top Cover

Top Cover Seal

Micro Spacer
0.25mm (PAT.)

Star Compression Ring (PAT.)

Double Seals
Premium Bearing 45°

Double Seals
Premium Bearing
45° or 36° by Order

Crown Race 45° or 36°
by Order



Cable Box Intro



Cable Box Installation Info

AERO Integrated Cable Routing System



A-BOX

IS52/28.6 | IS52/40

Head Tube Size:

Top TIDxTD: Dia.52x8.7mm

Bottom BIDxBD: Dia.52x7mm

Model:

TK155 w/Carbon Top Cover

TK155P w/Composite Top Cover

Stem

Model: RDT175

Stem Length: 80, 105mm

Angle: -17.5°

Material: Alloy

Colour: Black



Full Integrated Handle Bar

Model: WING20C+/ ERGO/ 35 SLC

Width: 380, 400, 420mm (center to center)

Basebar Width: 420mm (center-to-center)

Extension Angle: 35°

Armrest Rotation: 7°

Bracket Tilt Adjustment: 0-15°

Material: Carbon

Colour: Matte Black



Cable Box Intro



Cable Box Installation Info



PROMAX



TOKEN®

AERO Integrated Cable Routing System

Stem

Model: RA-204

Stem Weight: 213.7g (80mm)

Stem Length: 80, 90, 100, 110mm

Angle: -6°

Material: Alloy

Handle Bar

Model: HB-3057DBIR

Bar Weight: 314g (420mm)

Bar Size (C-C): 380, 400, 420, 440, 460, 480, 500mm

Bar Drop: 125mm

Bar Reach: 70mm

Flare out: 16°

Material: Alloy

A-BOX

IS52/28.6 | IS52/40

Head Tube Size:

Top TIDxTD: Dia.52x8.7mm

Bottom BIDxBD: Dia.52x7mm

Model:

TK155 w/Carbon Top Cover

TK155P w/Composite Top Cover

Speed Addict Spacer
5mm / 10mm
by Order

Top Cover

Top Cover Seal

Micro Spacer
0.25mm (PAT.)

Star Compression Ring (PAT.)

Double Seals
Premium Bearing 45°

Double Seals
Premium Bearing
45° or 36° by Order

Crown Race 45° or 36°
by Order



Cable Box Intro



Cable Box Installation Info



PROMAX



TOKEN®

AERO Integrated Cable Routing System

Stem

Model: RA-204

Stem Weight: 213.7g (80mm)

Stem Length: 80, 90, 100, 110mm

Angle: -6°

Material: Alloy

Handle Bar

Model: HB-3050DBIR

Bar Weight: 306g (420mm)

Bar Size (C-C): 400, 420, 440mm

Bar Drop: 130mm

Bar Reach: 65mm

Flare out: 12°

Material: Alloy

A-BOX

IS52/28.6 | IS52/40

Head Tube Size:

Top TIDxTD: Dia.52x8.7mm

Bottom BIDxBD: Dia.52x7mm

Model:

TK155 w/Carbon Top Cover

TK155P w/Composite Top Cover

Speed Addict Spacer
5mm / 10mm
by Order



Top Cover



Top Cover Seal



Micro Spacer
0.25mm (PAT.)



Star Compression Ring (PAT.)



Double Seals
Premium Bearing 45°



Double Seals
Premium Bearing
45° or 36° by Order



Crown Race 45° or 36°
by Order



Cable Box Intro



Cable Box Installation Info



PROMAX



TOKEN®

AERO Integrated Cable Routing System

Stem

Model: MA-504ELC

Stem Weight: 435.5g (110mm)

Clamp I.D.: Ø25.4 / Ø28.6mm

Stem Length: 80, 90, 100, 110, 120mm

Stack Height: 40mm

Angle: 90°~140°

Material: Alloy

Handle Bar

Model: HB-3188DBIR

Bar Weight: 340g (780mm)

Bar Size (C-C): 780, 880mm

Back Sweep: 8°

Up Sweep: 4°

Material: Alloy

A-BOX

ZS56/28.6 | ZS56/40

Head Tube Size:

Top TIDxTD: Dia.56x15mm

Bottom BIDxBD: Dia.56x15mm

Model:

TK155 w/Carbon Top Cover

TK155P w/Composite Top Cover



Speed Addict Spacer
5mm / 10mm
by Order



Top Cover



Top Cover Seal



Micro Spacer
0.25mm (PAT.)



Star Compression Ring (PAT.)



Double Seals
Premium Bearing 45°



Upper / Lower Cup
by Order



Double Seals
Premium Bearing
45° or 36° by Order



Crown Race 45° or 36°
by Order



Forged Stem
Angle: 90°



Forged Stem
Angle: 140°



Cable Box Intro

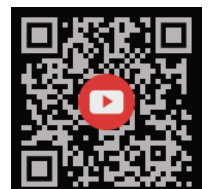

Cable Box Installation Info



PROMAX



TOKEN®

AERO Integrated Cable Routing System

Stem

Model: DA-2012

Stem Weight: 188.4g (50mm)

Stem Length: 50mm

Bar Bore: Dia.31.8mm

Material: Alloy

Handle Bar

Model: HB-3188DBIR

Bar Weight: 340g (780mm), 350g (800mm)

Bar Size (C-C): 780, 800mm

Bar Bore: Dia.31.8mm

Bar Sweep: 8°

Up Sweep: 4°

Material: Alloy

A-BOX

IS52/28.6 | IS52/40

Head Tube Size:

Top TIDxTD: Dia.52x8.7mm

Bottom BIDxBD: Dia.52x7mm

Model:

TK155 w/Carbon Top Cover

TK155P w/Composite Top Cover



Speed Addict Spacer
5mm / 10mm
by Order

Top Cover

Top Cover Seal

Micro Spacer
0.25mm (PAT.)

Star Compression Ring (PAT.)

Double Seals
Premium Bearing 45°

Upper / Lower Cup
by Order

Double Seals
Premium Bearing
45° or 36° by Order

Crown Race 45° or 36°
by Order



Cable Box Intro



Cable Box Installation Info



PROMAX



TOKEN®

AERO Integrated Cable Routing System

Stem

Model: DA-20125

Stem Weight: 189g (50mm)

Stem Length: 50mm

Bar Bore: Dia.35mm

Material: Alloy

Handle Bar

Model: HB-3235DBIR

Bar Weight: 345g (800mm)

Bar Size (C-C): 800mm

Bar Bore: Dia.35mm

Bar Sweep: 8°

Up Sweep: 4°

Material: Alloy

A-BOX

IS52/28.6 | IS52/40

Head Tube Size:

Top TIDxTD: Dia.52x8.7mm

Bottom BIDxBD: Dia.52x7mm

Model:

TK155 w/Carbon Top Cover

TK155P w/Composite Top Cover



Speed Addict Spacer
5mm / 10mm
by Order



Top Cover



Top Cover Seal



Micro Spacer
0.25mm (PAT.)



Star Compression Ring (PAT.)



Double Seals
Premium Bearing 45°



Upper / Lower Cup
by Order

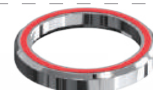

Double Seals
Premium Bearing
45° or 36° by Order



Crown Race 45° or 36°
by Order



Cable Box Intro



Cable Box Installation Info

Semi-Integrated Cable Routing System with Cable Cover

Stem

Model: ST278A

Stem Length:

80, 90, 100, 110, 120mm

Angle: -7°

Material: Alloy

Colour: Black

Cable holding included

Handlebar

Model: RA130AH

Bar Drop: 121mm

Bar Reach: 74mm

Bar Size (C-C): 380, 400, 420, 440mm

Material: Alloy

Colour: Black

C-BOX (KIT)

IS52/28.6 | IS52/40

Head Tube Size:

Top TIDxTD: Dia.52x8.7mm

Bottom BIDxBD: Dia.52x7mm

Model:

TK155 w/Carbon Top Cover

TK155P w/Composite Top Cover

Cable Cover

Speed Addict Spacer
5mm / 10mm
by Order

Top Cover

Top Cover Seal

Micro Spacer
0.25mm (PAT.)

Star Compression Ring (PAT.)

Double Seals
Premium Bearing 45°

Double Seals
Premium Bearing
45° or 36° by Order

Crown Race 45° or 36°
by Order



Cable Box Intro



Cable Box Installation Info

AERO Integrated Cable Routing System

Stem

Model: ST279A

Stem Length:

80, 90, 100, 110, 120mm

Angle: -10°

Material: Alloy

Colour: Black

Handlebar

Model: RA130AH

Bar Drop: 121mm

Bar Reach: 74mm

Bar Size (C-C): 380, 400, 420, 440mm

Material: Alloy

Colour: Black

A-BOX (KIT)

IS52/28.6 | IS52/40

Head Tube Size:

Top TIDxTD: Dia.52x8.7mm

Bottom BIDxBD: Dia.52x7mm

Model:

TK155 w/Carbon Top Cover

TK155P w/Composite Top Cover

Speed Addict Spacer
5mm / 10mm
by Order



Crown Race 45° or 36°
by Order



Cable Box Intro



Cable Box Installation Info

AERO Integrated Cable Routing System

Stem

Model: TDS-D636-8 FOV

Stem Length: 75, 90, 105mm

Angle: 0° ~ 60°

Material: Alloy

Colour: Black



5mm / 10mm Spacer
by Order

A-BOX

IS52/28.6 I IS52/40

Head Tube Size:

Top TIDxTD: Dia.52x8.7mm

Bottom BIDxBD: Dia.52x7mm

Model:

TK155ZM w/Composite Top Cover



Cable Box Intro



Cable Box Installation Info

Semi-Integrated Cable Routing System



Stem

Model: TDS-RD703-8FOV

Stem Length: 90, 100, 110, 120, 130 mm

Angle: -7°

Material: Alloy

Colour: Black

S-BOX

IS52/28.6 | IS52/40

Head Tube Size:

Top TIDxTD: Dia.52x8.7mm

Bottom BIDxBD: Dia.52x7mm

Model:

TK1556SPH w/Crown Race

TK155SPH w/o Crown Race



Cable Seal Option for Wide Compatibility

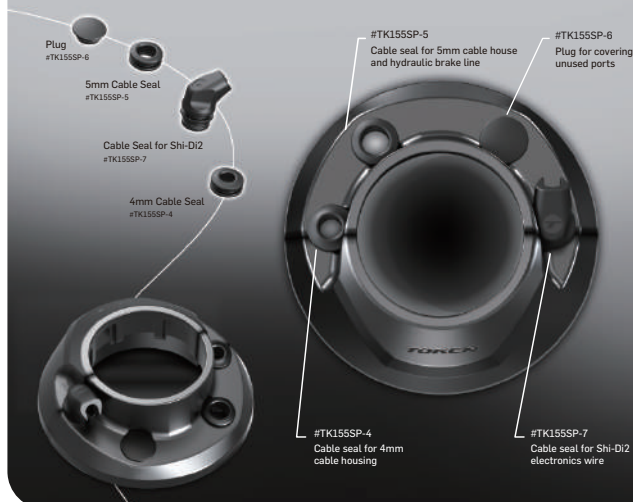

Cable Box Intro

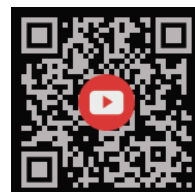

Cable Box Installation Info

Semi-Integrated Cable Routing System

Stem

Model: TDS-RD702-8FOV

Stem Length: 80, 90, 100, 110, 120, 130mm

Angle: -10°

Material: Alloy

Colour: Black

S-BOX

IS52/28.6 I IS52/40

Head Tube Size:

Top TIDxTD: Dia.52x8.7mm

Bottom BIDxBD: Dia.52x7mm

Model:

TK1556SPH w/Crown Race

TK155SPH w/o Crown Race

5mm / 10mm Spacer
by Order

Top Cover

Top Cover Seal

Micro Spacer
0.25mm (PAT.)

Star Compression Ring (PAT.)

Double Seals
Premium Bearing 45°

Upper / Lower Cup
by Order

Double Seals
Premium Bearing
45° or 36° by Order

Crown Race 45° or 36°
by Order



Cable Seal Option for Wide Compatibiliy

Plug
#TK155SP-6

5mm Cable Seal
#TK155SP-5

Cable Seal for Shi-Di2
#TK155SP-7

4mm Cable Seal
#TK155SP-4

#TK155SP-5
Cable seal for 5mm cable house
and hydraulic brake line

#TK155SP-6
Plug for covering
unused ports

#TK155SP-4
Cable seal for 4mm
cable housing

#TK155SP-7
Cable seal for Shi-Di2
electronics wire



Cable Box Intro

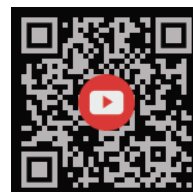

Cable Box Installation Info



A-BOX

AERO Integrated Cable Routing System

TK155-4-P5
TK155-4-P10

SPEED-ADDICT Spacers (pair) for A-Box Headset
Available In 5mm and 10mm Height

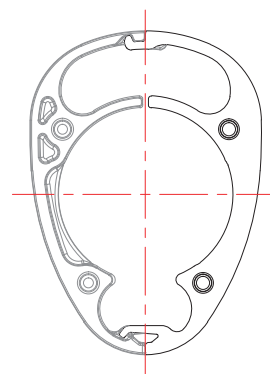
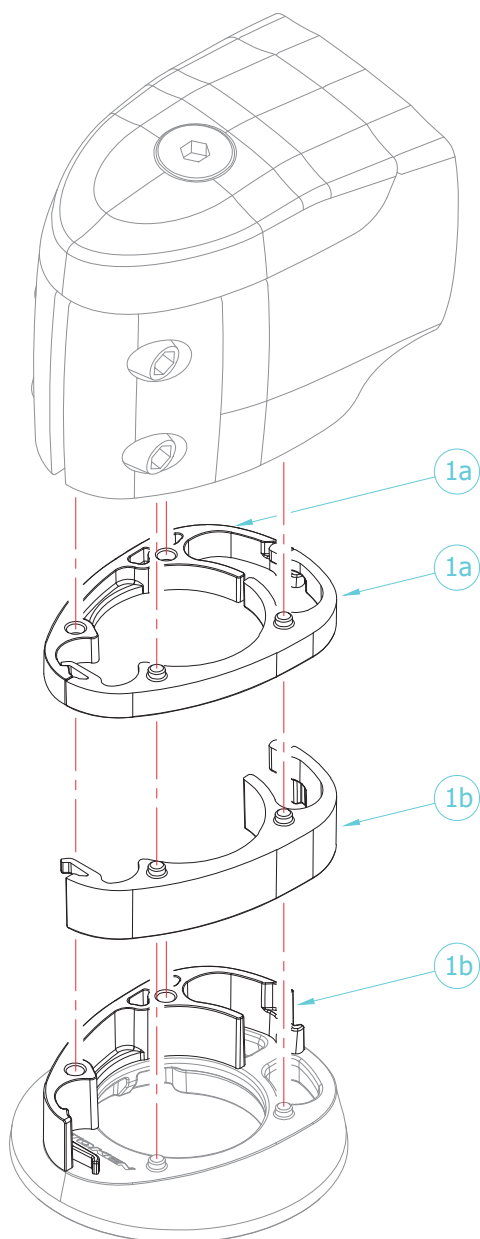

Designed for aerodynamic and quick adjustment.

- Pin-and-hole interface.
- Flip-flop design.
- Light weight composite material.

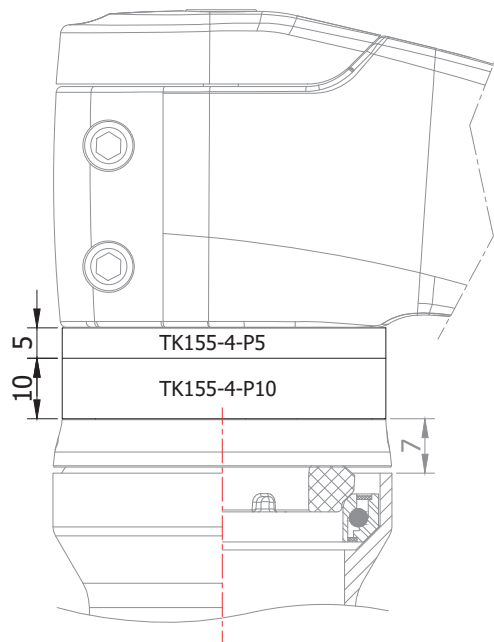

No.	Item	Material	Drawing	Q'ty
1a	Speed-Addict Spacer 5mm	Composite	TK155-4-P5	2
1b	Speed-Addict Spacer 10mm	Composite	TK155-4-P10	2
Unit: mm		Scale: 1.25:1	Version: A 2020.05.04	

TK155
TK155P

A-Box Headset w/ Carbon Top Cover
(TK155P: With ① GF-Composite Top Cover TK155-2)

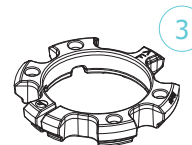
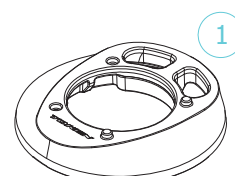
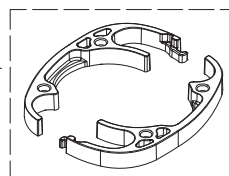
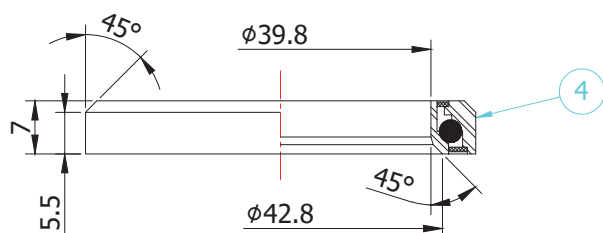
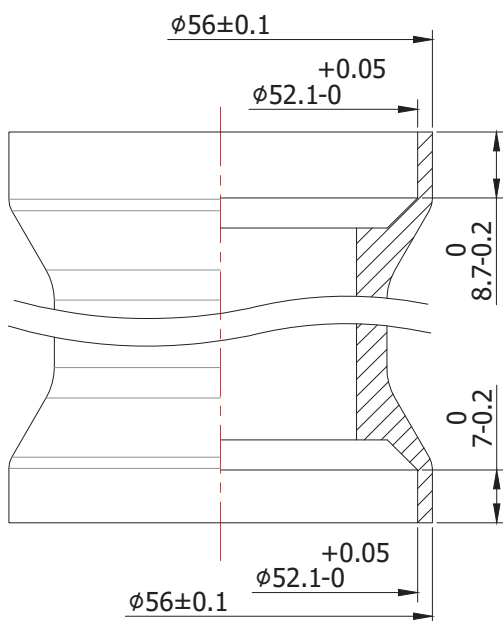
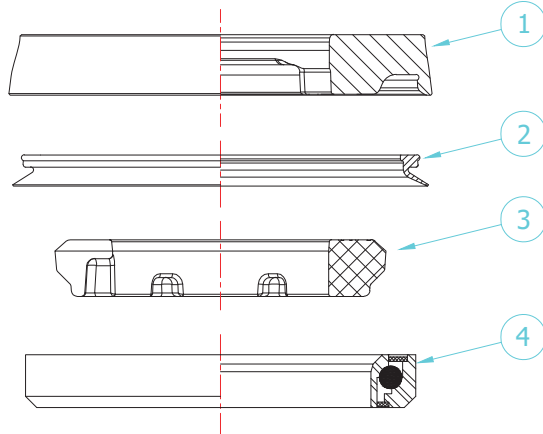
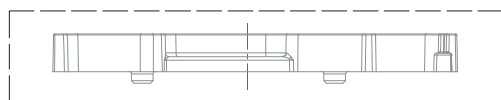

Spacers (Not Included)
Available in 5mm & 10mm

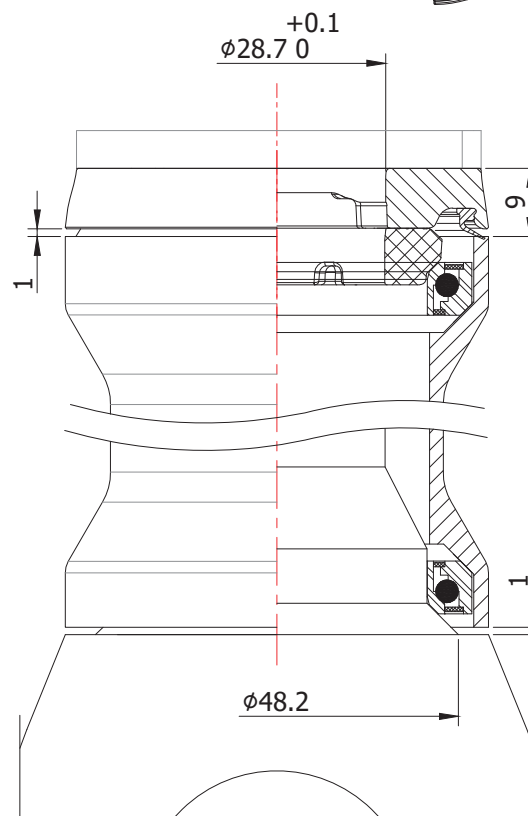

Stack Height: 9+1=10mm

SHIS code: IS52/28.6 | IS52/40

No.	Item	Material	Drawing	Q'ty
1	Top Cover	Carbon Composite	TK155-2C	1
2	Seal	NBR	TK155-1	1
3	Compression Ring	Composite	TK155-3	1
4	Sealed Bearing	Steel	ACB52H7/4	2

Unit: mm

Scale: 1:1

Revision: D
2020.05.08

TOKEN HEADSET TECHNICAL MANUAL

TK155-36 TK155P-36

A-Box Headset w/ Carbon Top Cover and 36°/45° Lower Bearing
(TK155P-36: With ① GF-Composite Top Cover TK155-2)

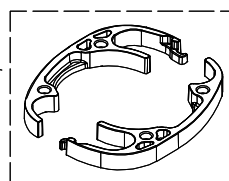
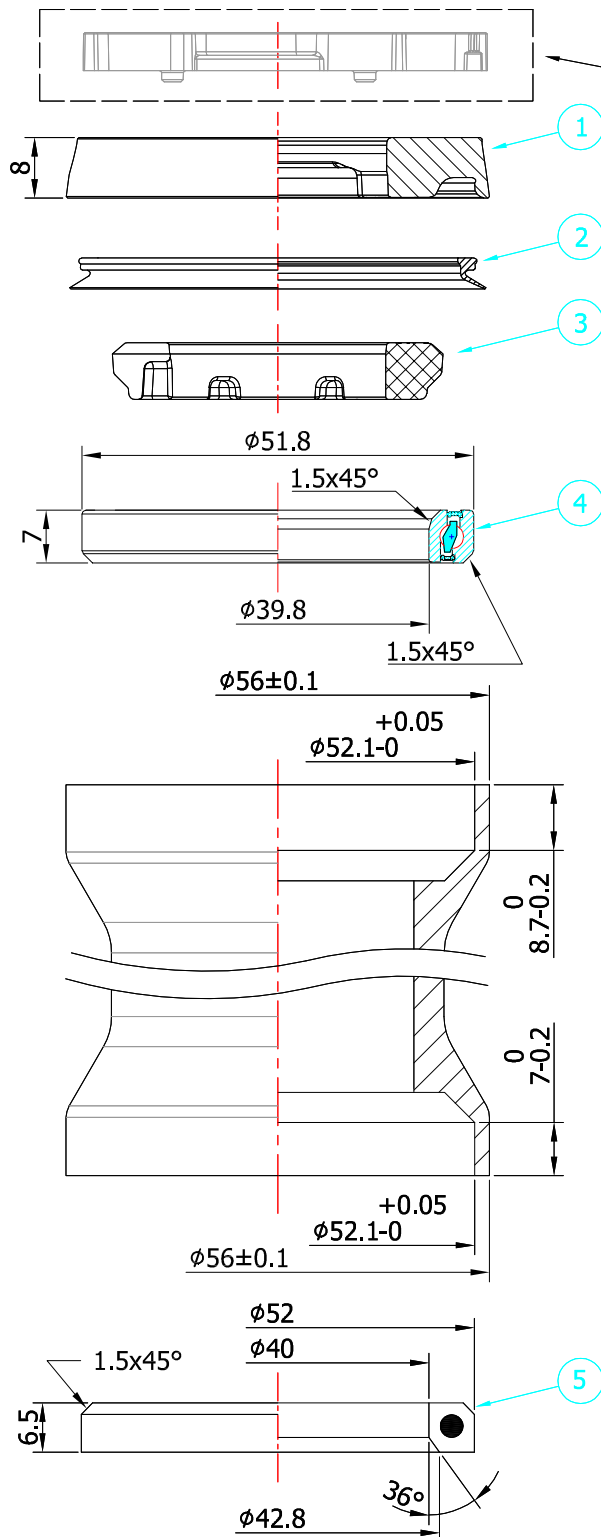

Spacers (Not Included)
Available in 5mm & 10mm

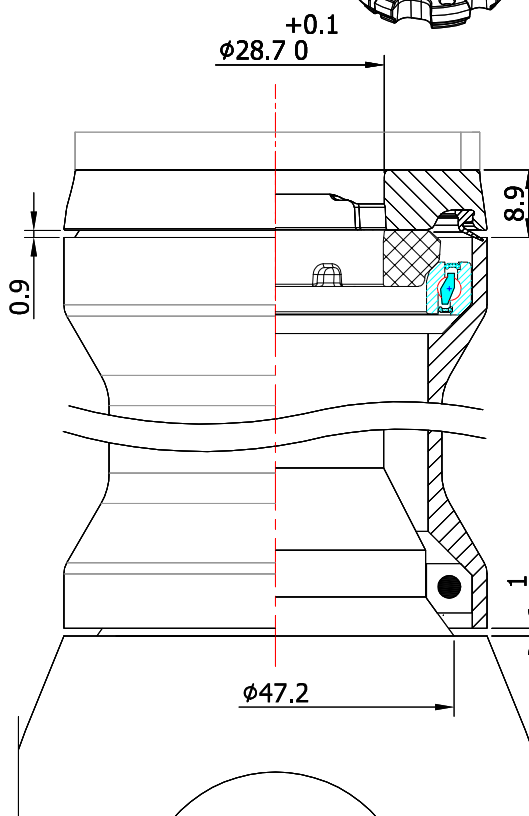
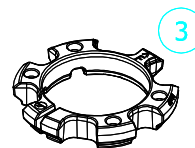
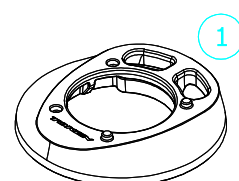

Stack Height: 8.9+1=9.9mm

SHIS code: IS52/28.6 | IS52/40

No.	Item	Material	Drawing	Q'ty
1	Top Cover	Carbon Composite	TK155-2C	1
2	Seal	NBR	TK155-1	1
3	Compression Ring	Composite	TK155-3	1
4	Sealed Bearing	Steel	ACB52H7/4	1
5	Sealed Bearing	Steel	TK52H65	1

Unit: mm

Scale: 1:1

Revision: D
2021.11.01

TK1556
TK1556P

A-Box Headset w/ Carbon Top Cover and Alloy Crown Race
(TK1556P: With ① GF-Composite Top Cover TK155-2)

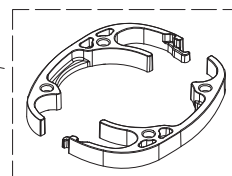
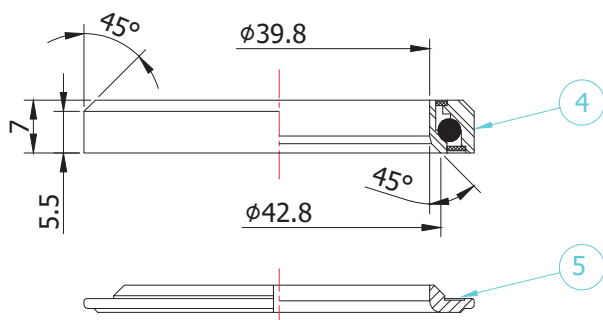
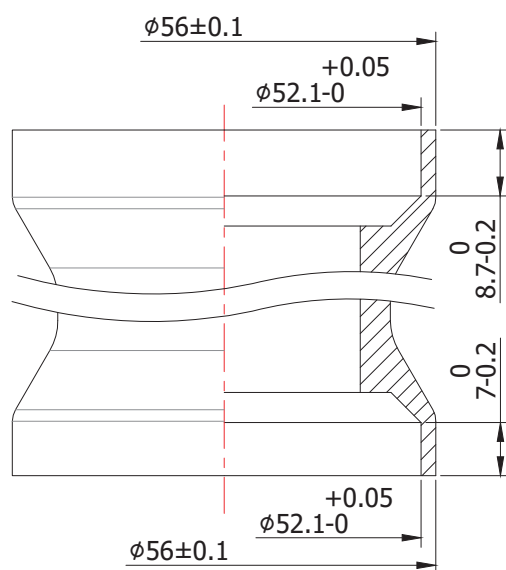
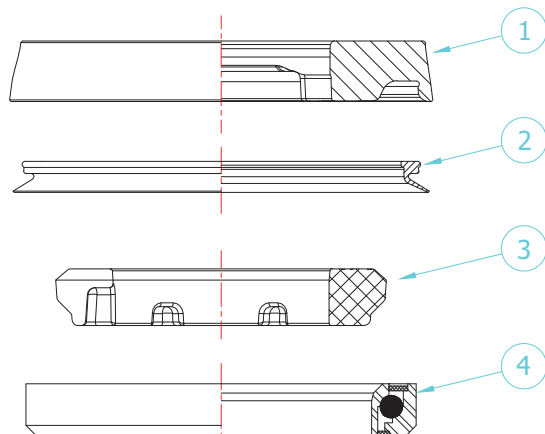
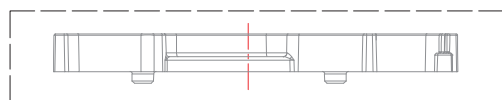

Spacers (Not Included)
Available in 5mm & 10mm

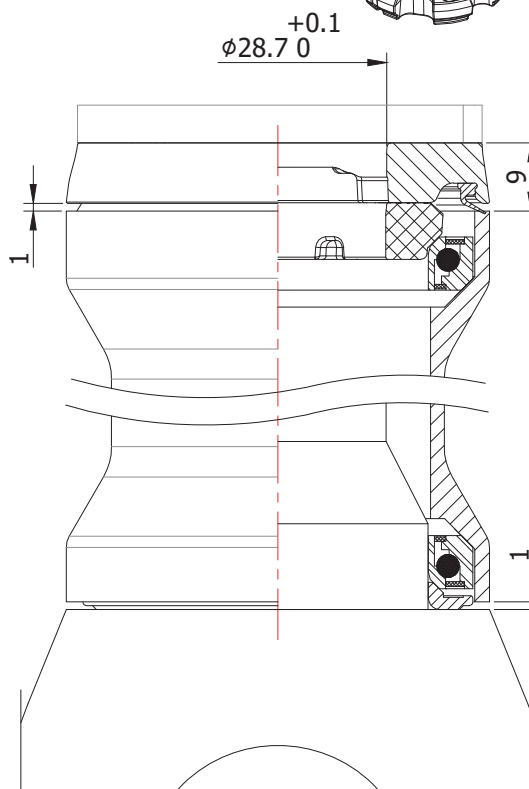
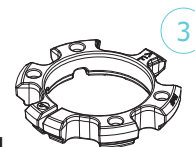
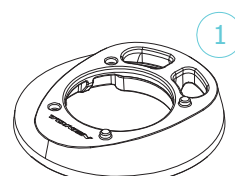

Stack Height: 9+1=10mm

SHIS code: IS52/28.6 | IS52/40

No.	Item	Material	Drawing	Q'ty
1	Top Cover	Carbon Composite	TK155-2C	1
2	Seal	NBR	TK155-1	1
3	Compression Ring	Composite	TK155-3	1
4	Sealed Bearing	Steel	ACB52H7/4	2
5	Crown Race	Alloy	TK1556-6	1

Unit: mm

Scale: 1:1

Revision: B
2020.05.06

TK155-KIT

CABLE BOX Headset Bearing Kit

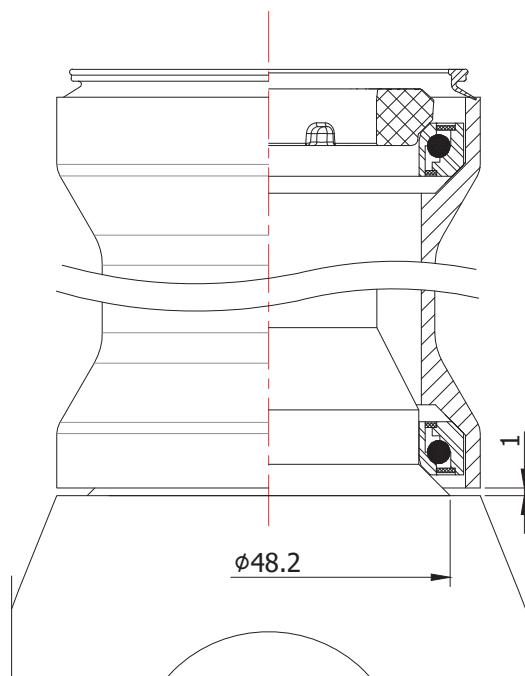
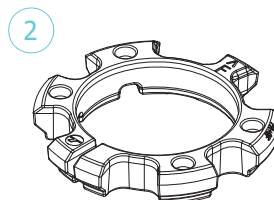
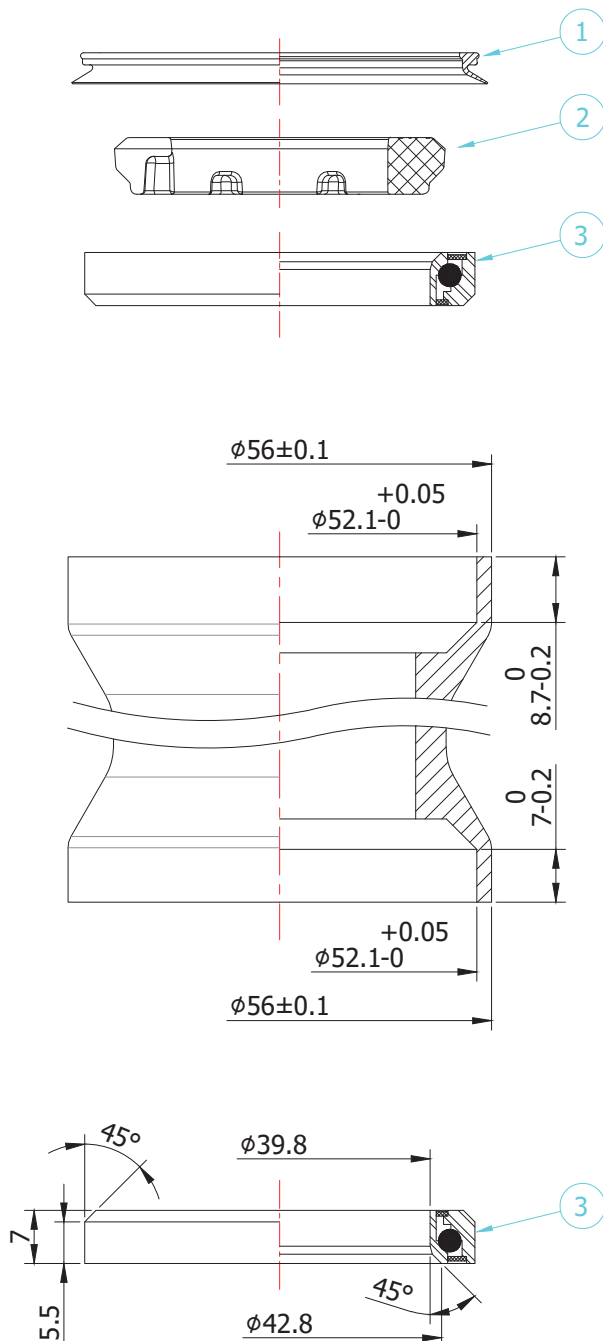

SHIS code: IS52/28.6 | IS52/40

No.	Item	Material	Drawing	Q'ty
1	Seal	NBR	TK155-1	1
2	Compression Ring	Composite	TK155-3	1
3	Sealed Bearing	Steel	ACB52H7/4	2
Unit: mm		Scale: 1:1		Version: B 2020.05.08

TK155-36-KIT

CABLE BOX Headset Bearing Kit

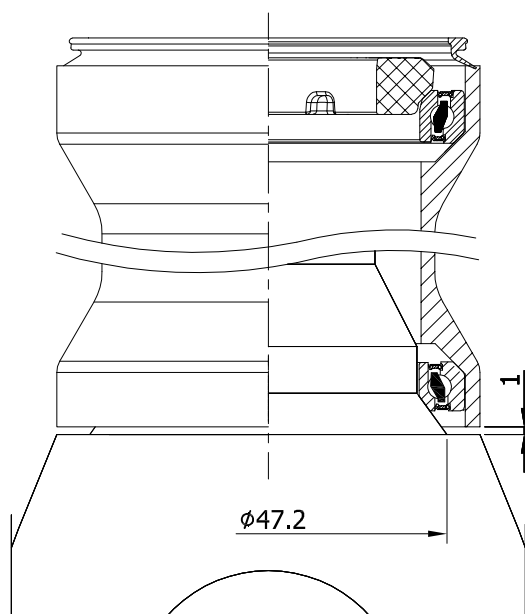
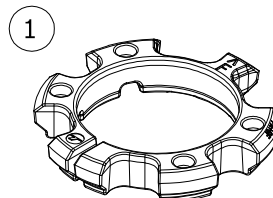
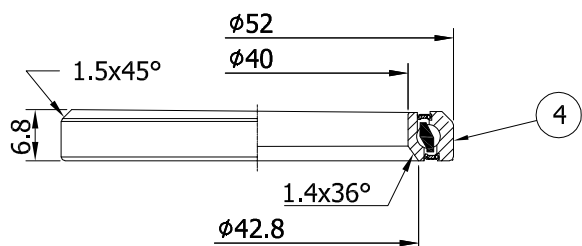
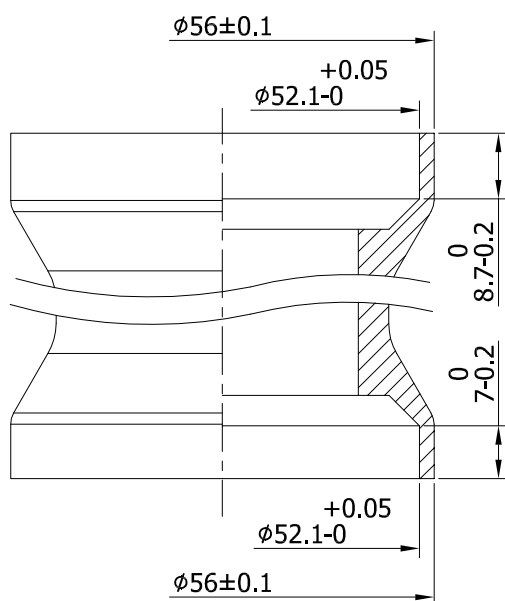
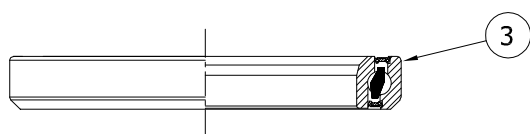
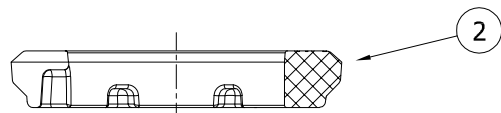

SHIS code: IS52/28.6 | IS52/40

No.	Item	Material	Drawing	Q'ty
1	Seal	NBR	TK155-1	1
2	Compression Ring	Composite	TK155-3	1
3	Premium Bearing	Steel	ACB52H7/4	1
4	Premium Bearing	Steel	TK52H65	1

Unit: mm

Scale: 1:1

 Revision: A
2021.12.16

TK1556-KIT

CABLE BOX Headset Bearing Kit with Crown Race

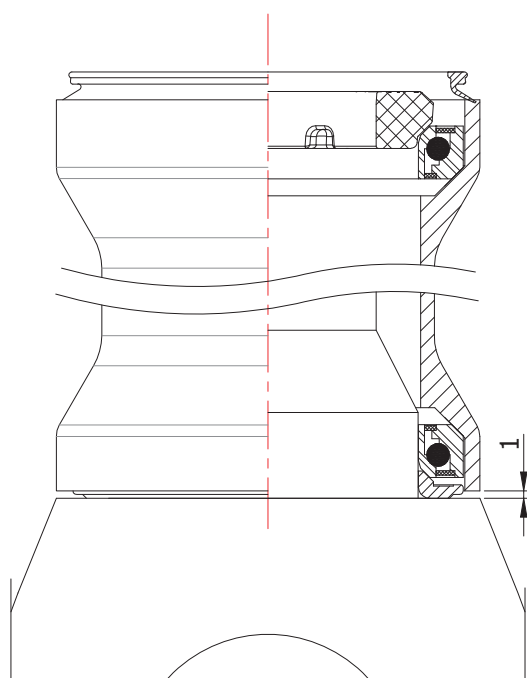
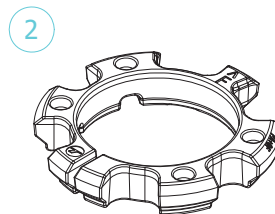
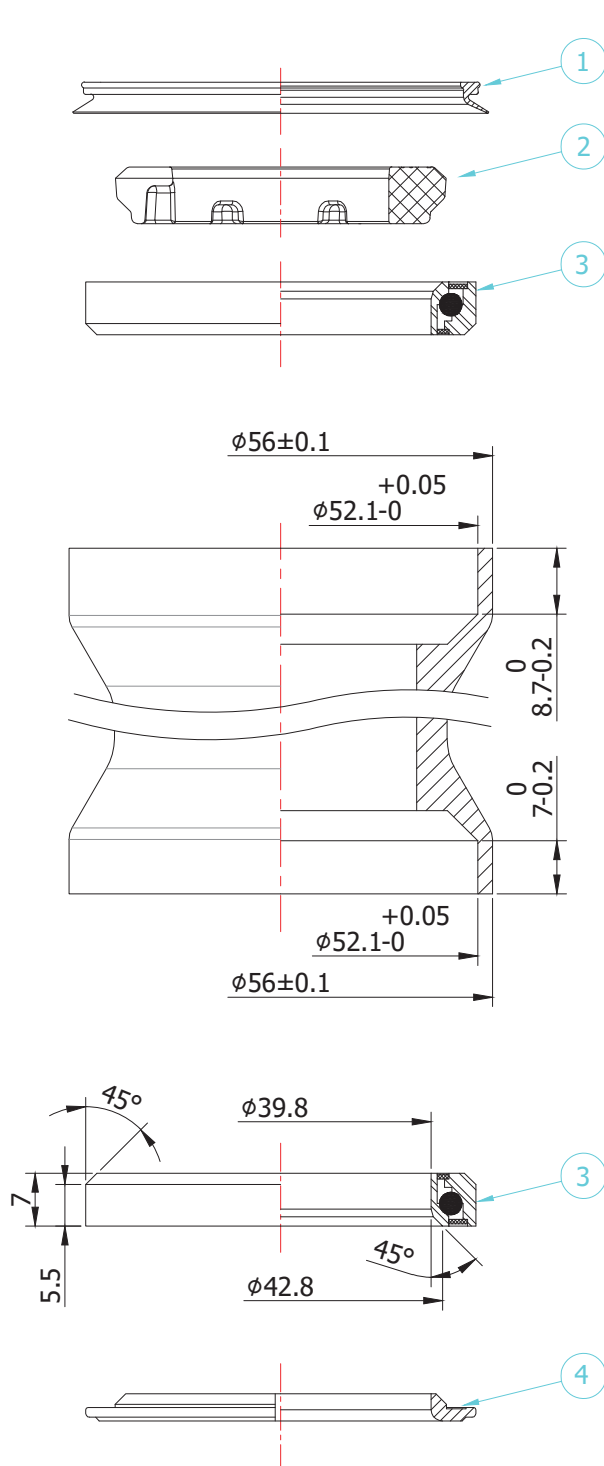

SHIS code: IS52/28.6 | IS52/40

No.	Item	Material	Drawing	Q'ty
1	Seal	NBR	TK155-1	1
2	Compression Ring	Composite	TK155-3	1
3	Sealed Bearing	Steel	ACB52H7/4	2
4	Crown Race	Alloy	TK1556-6	1

Unit: mm

Scale: 1:1

 Revision: C
2020.05.08

TK1566
TK1566P

A-Box Headset w/ Carbon Top Cover, Alloy Cups and Crown Race
(TK1566P: With ① GF-Composite Top Cover TK155-2)

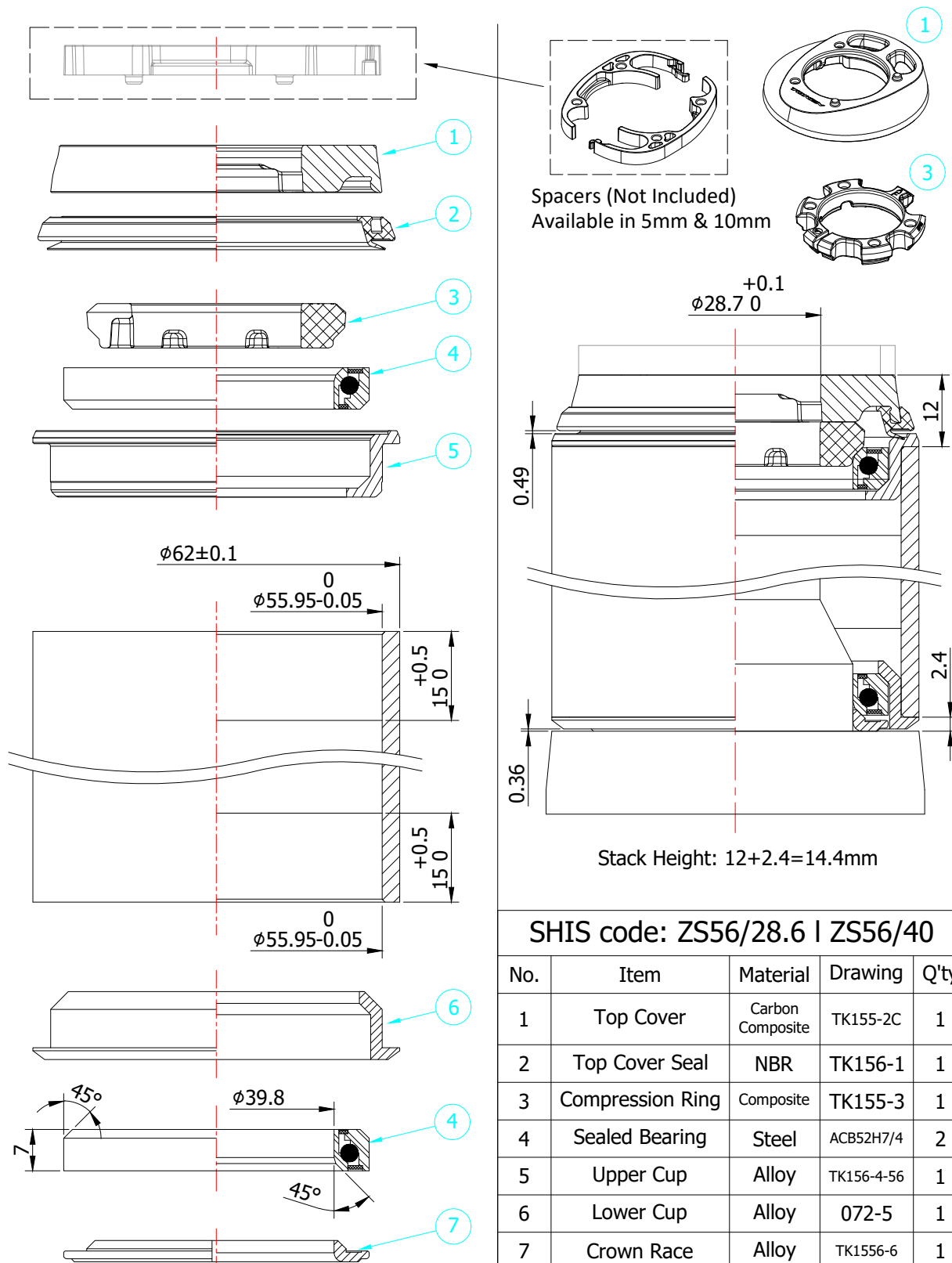

SHIS code: ZS56/28.6 | ZS56/40

No.	Item	Material	Drawing	Q'ty
1	Top Cover	Carbon Composite	TK155-2C	1
2	Top Cover Seal	NBR	TK156-1	1
3	Compression Ring	Composite	TK155-3	1
4	Sealed Bearing	Steel	ACB52H7/4	2
5	Upper Cup	Alloy	TK156-4-56	1
6	Lower Cup	Alloy	072-5	1
7	Crown Race	Alloy	TK1556-6	1

Unit: mm

Scale: 1:1

Revision: A
2021.01.05

TK1586
TK1586P

A-Box Headset w/ Carbon Top Cover

(TK1586P: With ① GF-Composite Top Cover TK155-2)

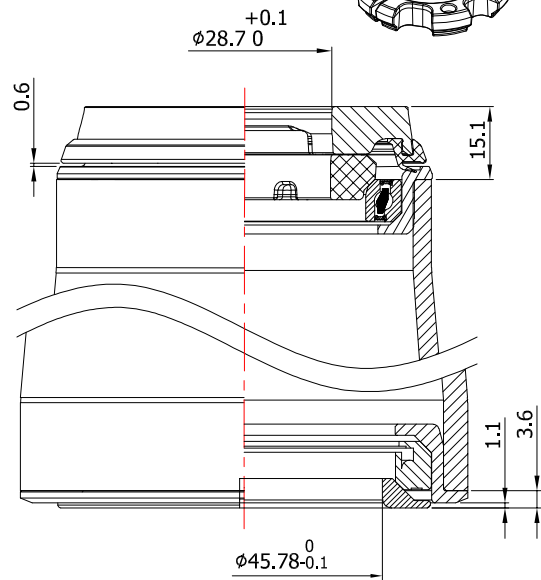
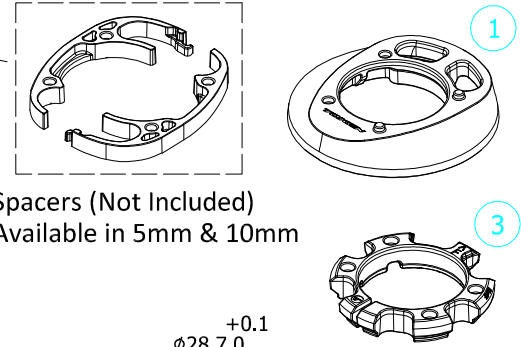
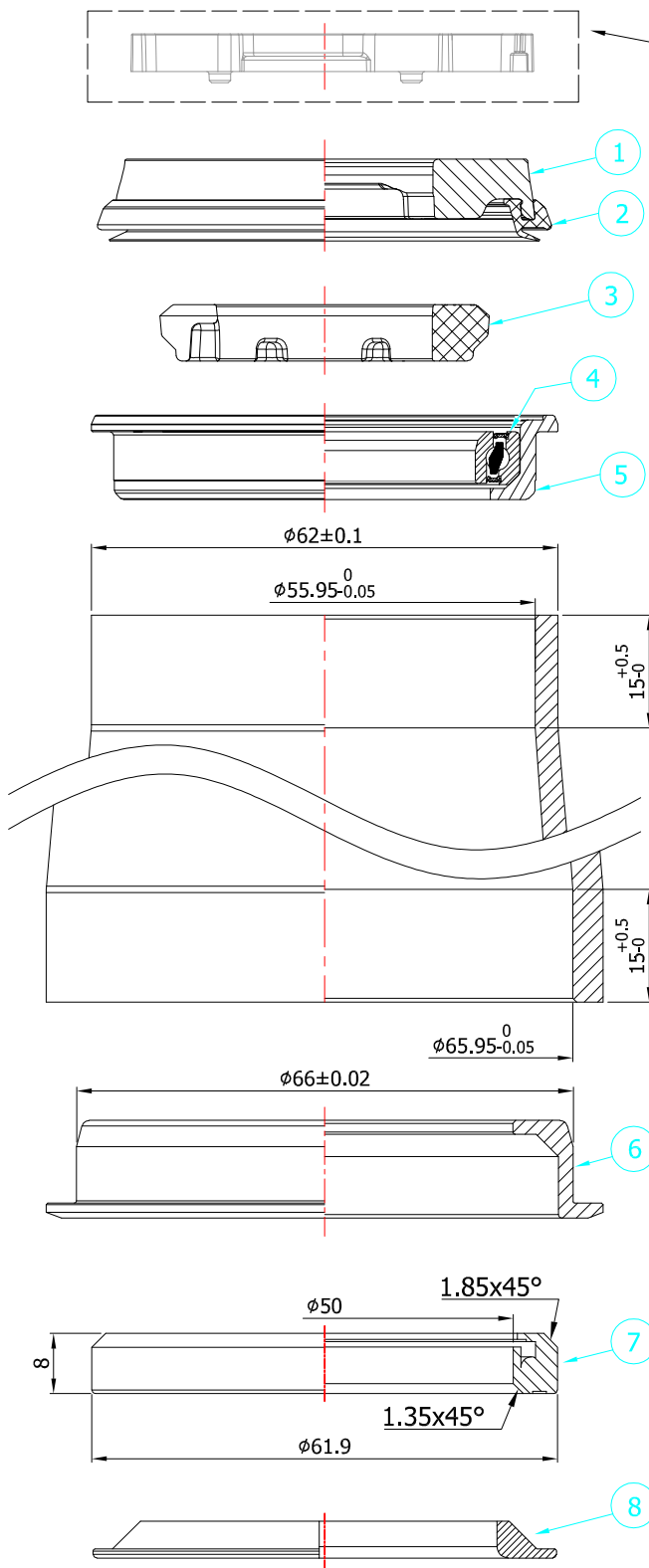

Scale = 0.8 : 1

Stack Height: 15.1+3.6=18.7mm

SHIS code: ZS6/28.6 | ZS66/45.8

No.	Item	Material	Drawing	Q'ty
1	Top Cover	Carbon Composite	TK155-2C	1
2	Top Cover Seal	NBR	TK156-1	1
3	Compression Ring	Composite	TK155-3	1
4	Premium Bearing	Steel	ACB52H7/4	1
5	Upper Cup	Alloy	TK156-4-56	1
6	Lower Cup	Alloy	072-5	1
7	Bearing	SUJ-2	ACB619	1
8	Crown Race	Alloy	TK188-6	1

Unit: mm

Scale: 1:1

Revision: A
2021.12.23

TK1536
TK1536P

A-Box Headset w/ Carbon Top Cover

(TK1536P: With ① GF-Composite Top Cover TK155-2)

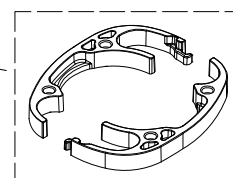
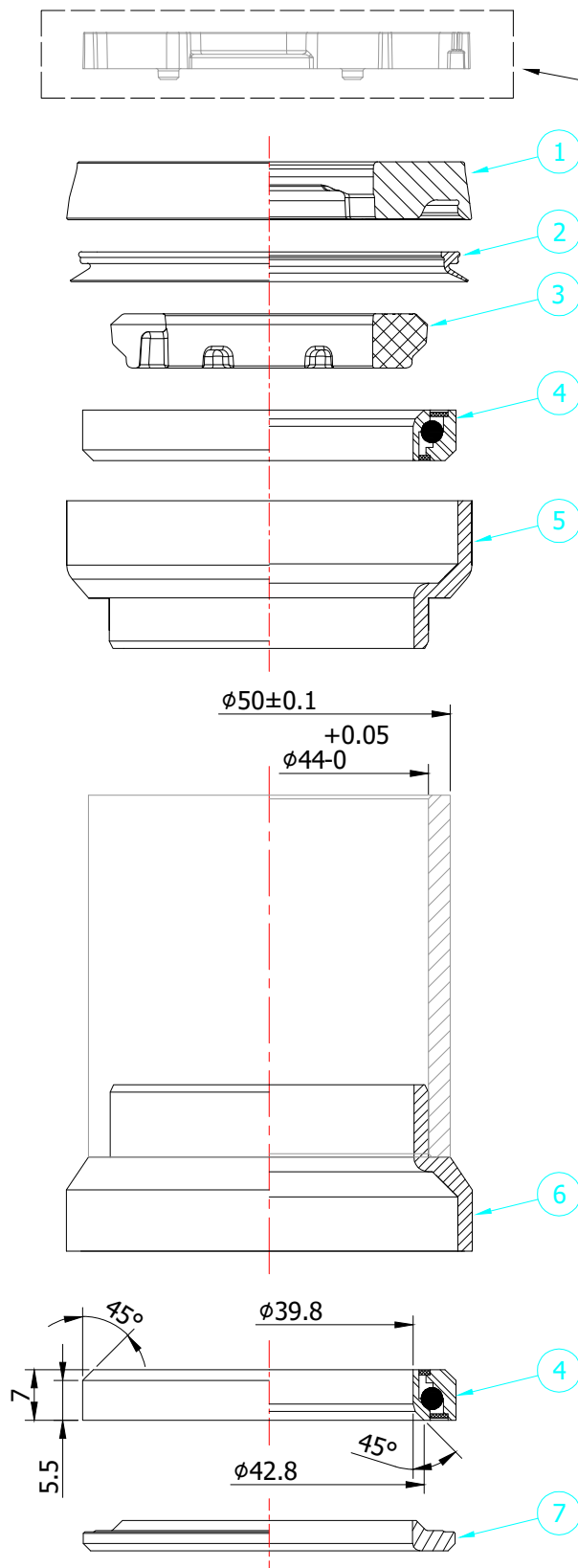

Spacers (Not Included)
Available in 5mm & 10mm

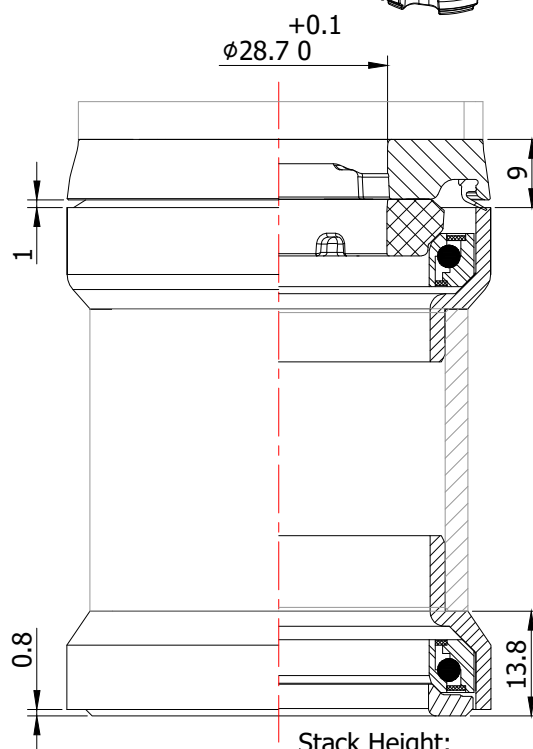
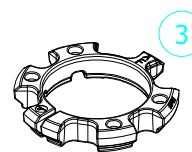
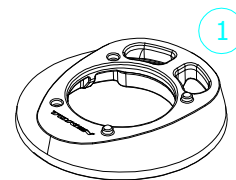

Stack Height:
9+13.8=22.8mm

SHIS code: EC44/28.6 | EC44/40

No.	Item	Material	Drawing	Q'ty
1	Top Cover	Carbon Composite	TK155-2C	1
2	Top Cover Seal	NBR	TK155-1	1
3	Compression Ring	Composite	TK155-3	1
4	Sealed Bearing	Steel	ACB52H7/4	2
5	Upper External Cup	Alloy	TK1536-4	1
6	Lower External Cup	Alloy	036T-5	1
7	Crown Race	Alloy	072-6/2	1

Unit: mm

Scale: 1:1

Revision: A
2021.01.21

TK1537
TK1537P

A-Box Headset w/ Carbon Top Cover

(TK1537P: With ① GF-Composite Top Cover TK155-2)

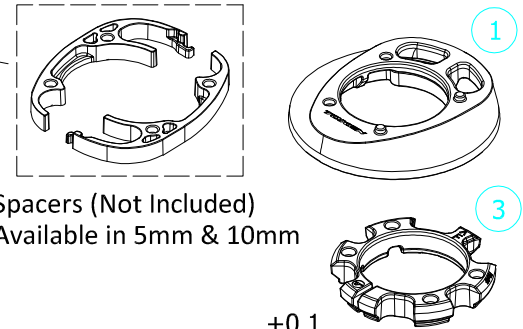
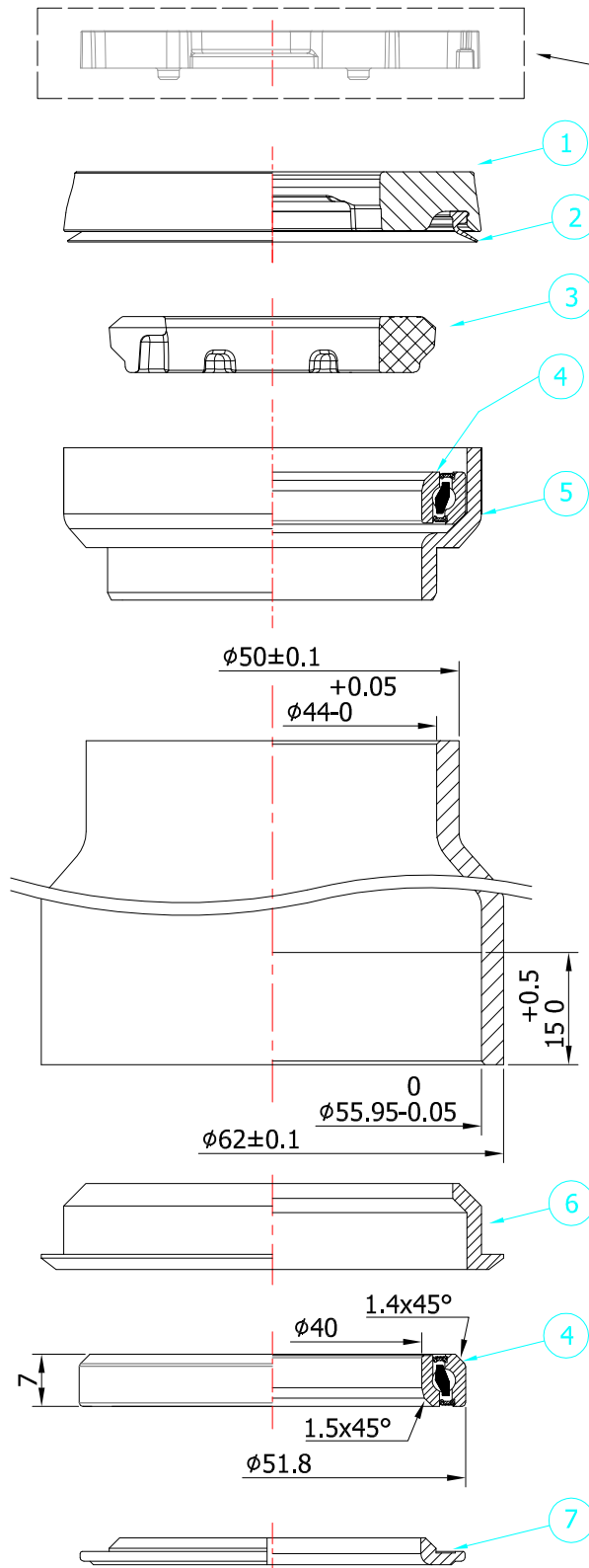

Spacers (Not Included)
Available in 5mm & 10mm

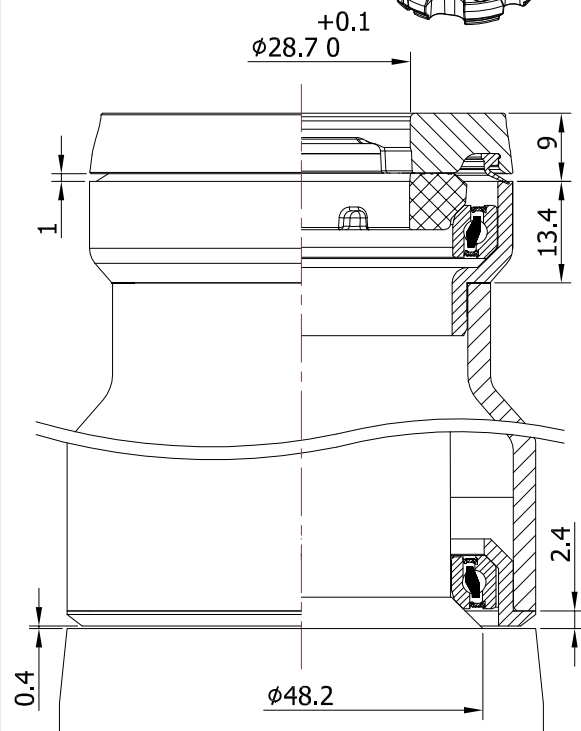

Stack Height: 8.9+2.4+13.4=24.7mm

SHIS code: EC44/28.6 | ZS56/40

No.	Item	Material	Drawing	Q'ty
1	Top Cover	Carbon Composite	TK155-2C	1
2	Seal	NBR	TK155-1	1
3	Compression Ring	Composite	TK155-3	1
4	Premium Bearing	Steel	ACB52H7/4	2
5	Upper External Cup	Alloy	TK1536-4	1
6	Lower Cup	Alloy	072-5	1
7	Crown Race	Alloy	TK1556-6	1

Unit: mm

Scale: 1:1

Revision: A
2021.12.27



S-BOX

Semi-Integrated Cable Routing System

TK155SP-CHHC

S-Box Headset

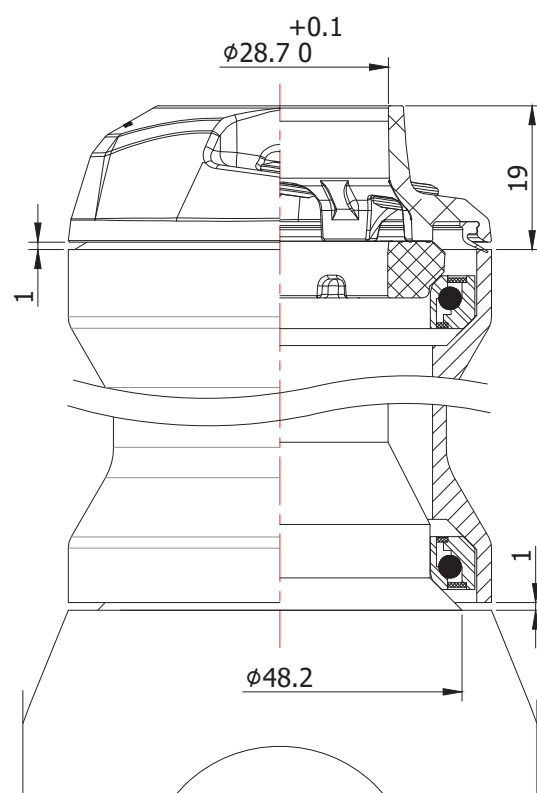
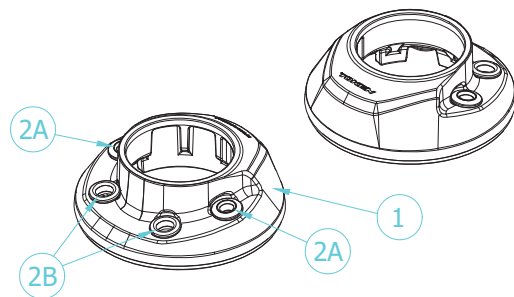
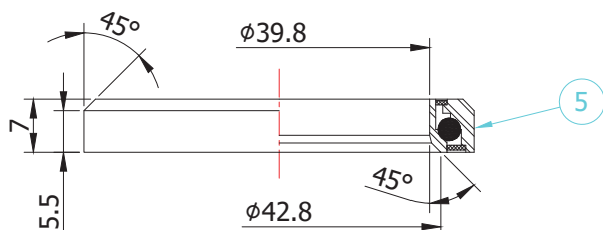
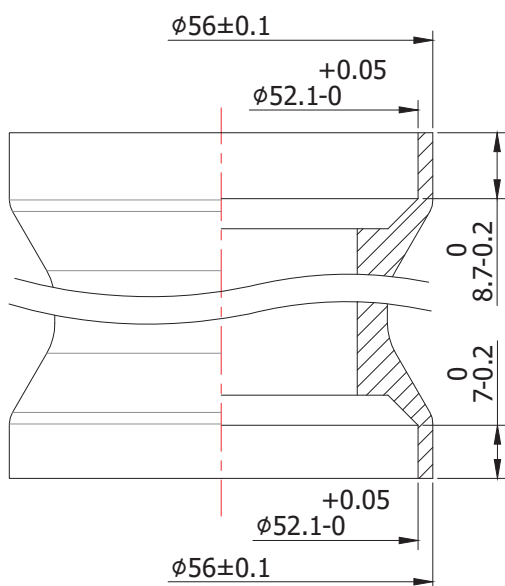
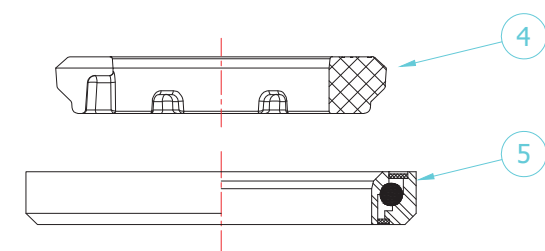
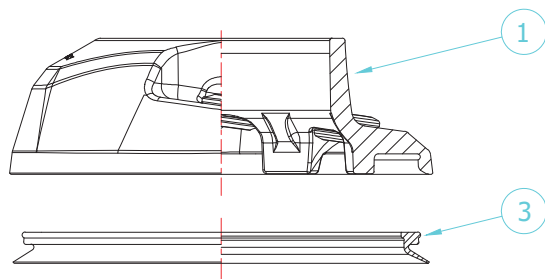
 For $\phi 4\text{mm}$ Housing x2 + $\phi 5\text{mm}$ Brake Line x2

 Stack Height: $19 + 1 = 20\text{mm}$

SHIS code: IS52/28.6 | IS52/40

No.	Item	Material	Drawing	Q'ty
1	Top Cover	Composite	TK155SP-1	1
2A	Housing Seal 4mm	NBR	TK155SP-4	2
2B	Housing Seal 5mm	NBR	TK155SP-5	2
3	Top Cover Seal	NBR	TK155-1	1
4	Compression Ring	Composite	TK155-3	1
5	Sealed Bearing	Steel	ACB52H7/4	2

Unit: mm

Scale: 1:1

 Revision: C
2020.05.08

TK155SPH

S-Box Headset / Proprietary Interface of HL Corp

For $\phi 4\text{mm}$ Housing x2 + $\phi 5\text{mm}$ Brake Line x2

(TK155SPH-TS-CHHC: With ⑤ Ti-Coated Bearings ACB52H7/4TS)

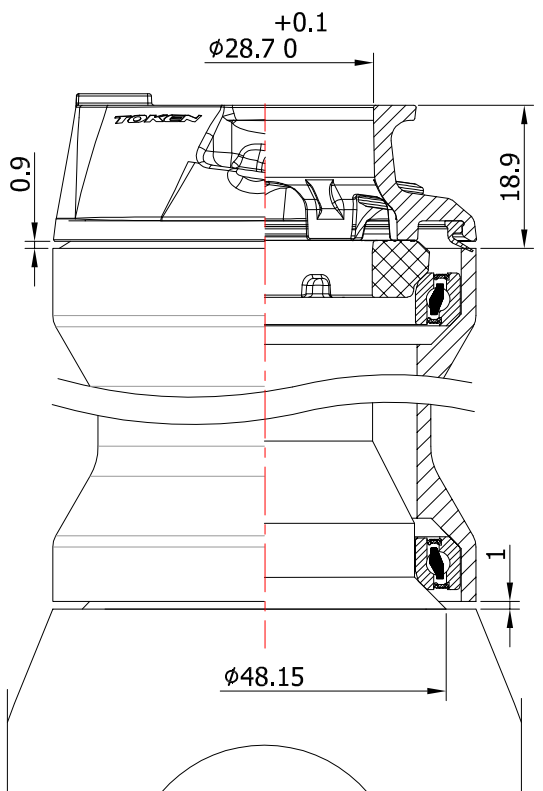
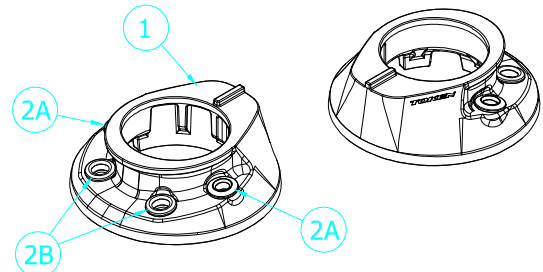
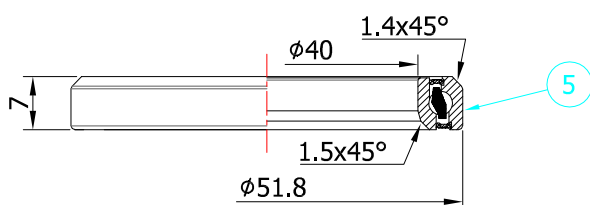
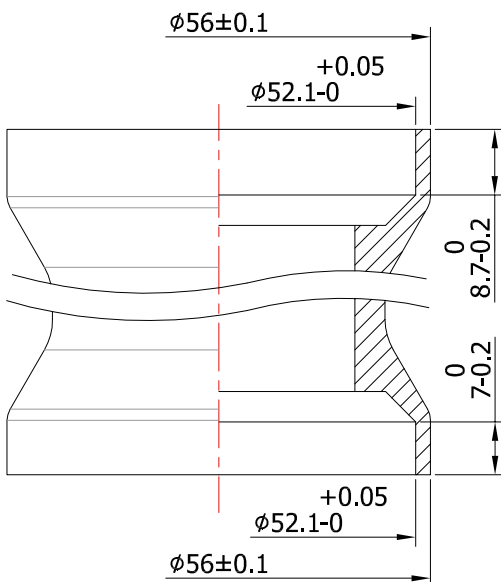
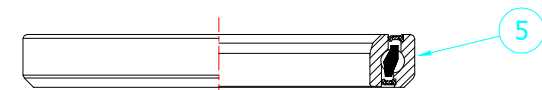
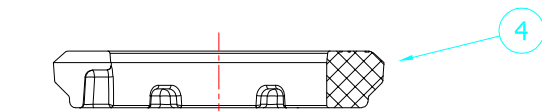
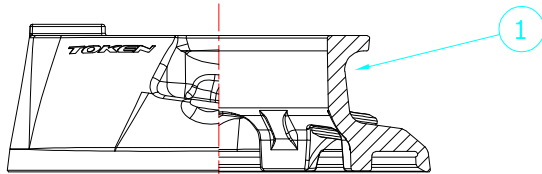

Stack Height: $18.9 + 1 = 19.9\text{mm}$

SHIS code: IS52/28.6 | IS52/40

No.	Item	Material	Drawing	Q'ty
1	Top Cover	Composite	TK155SPH-1	1
2A	Housing Seal 4mm	NBR	TK155SP-4	2
2B	Housing Seal 5mm	NBR	TK155SP-5	2
3	Top Cover Seal	NBR	TK155-1	1
4	Compression Ring	Composite	TK155-3	1
5	Premium Bearing	Steel	ACB52H7/4	2

Unit: mm

Scale: 1:1

Revision A

2021.12.23

TK155SP-36
S-Box Headset

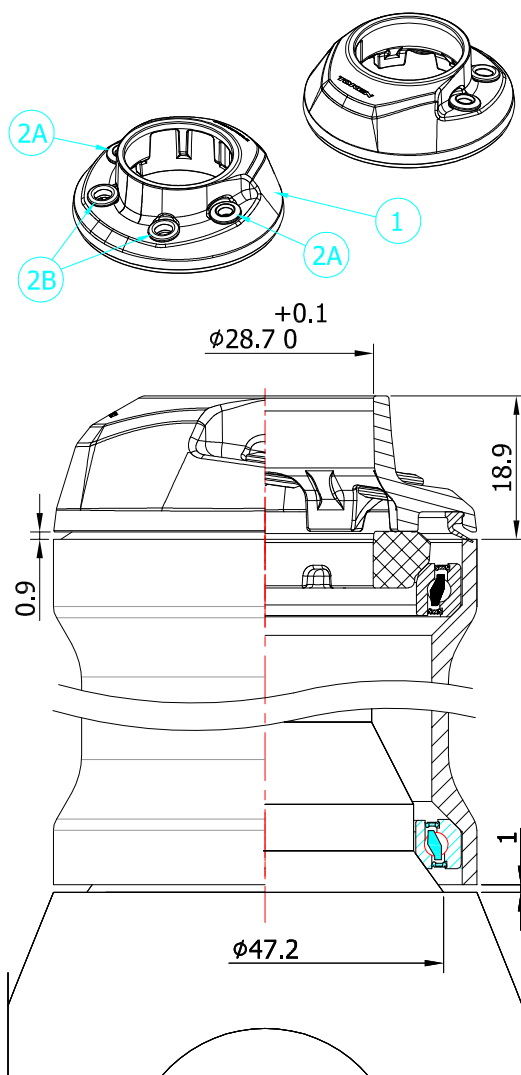
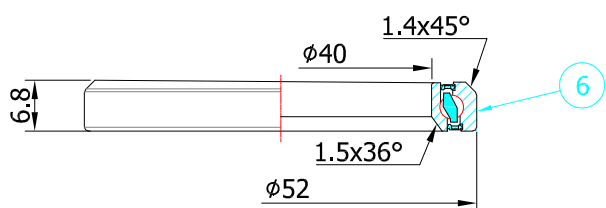
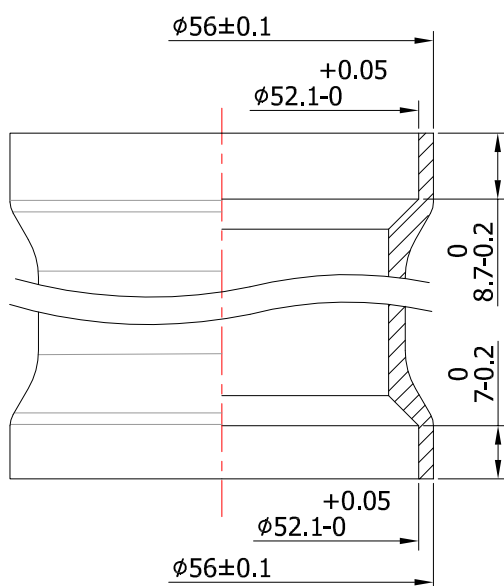
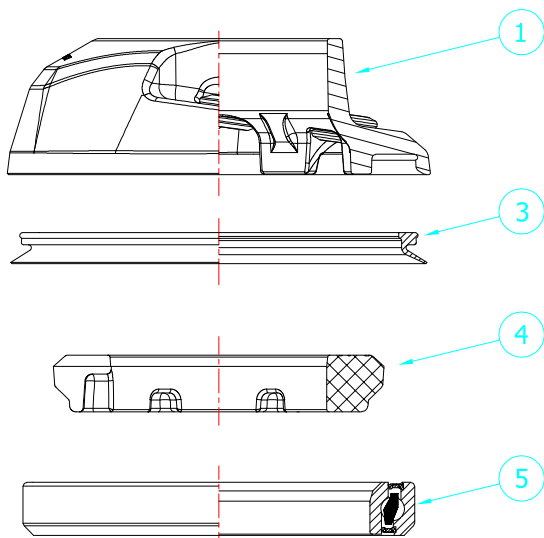
 For $\phi 4\text{mm}$ Housing x2 + $\phi 5\text{mm}$ Brake Line x2

 Stack Height: $18.9 + 1 = 19.9\text{mm}$
SHIS code: IS52/28.6 | IS52/40

No.	Item	Material	Drawing	Q'ty
1	Top Cover	Composite	TK155SP-1	1
2A	Housing Seal 4mm	NBR	TK155SP-4	2
2B	Housing Seal 5mm	NBR	TK155SP-5	2
3	Top Cover Seal	NBR	TK155-1	1
4	Compression Ring	Composite	TK155-3	1
5	Premium Bearing	Steel	ACB52H7/4	1
6	Premium Bearing	Steel	TK52H65	1

Unit: mm

Scale: 1:1

 Revision A
2021.12.23

TK1556SP-CHHC

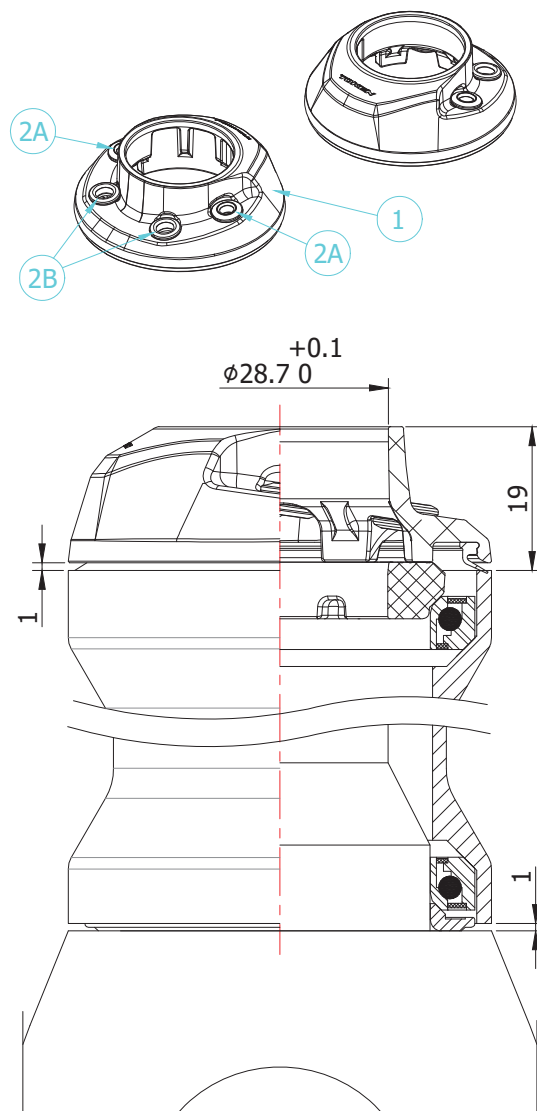
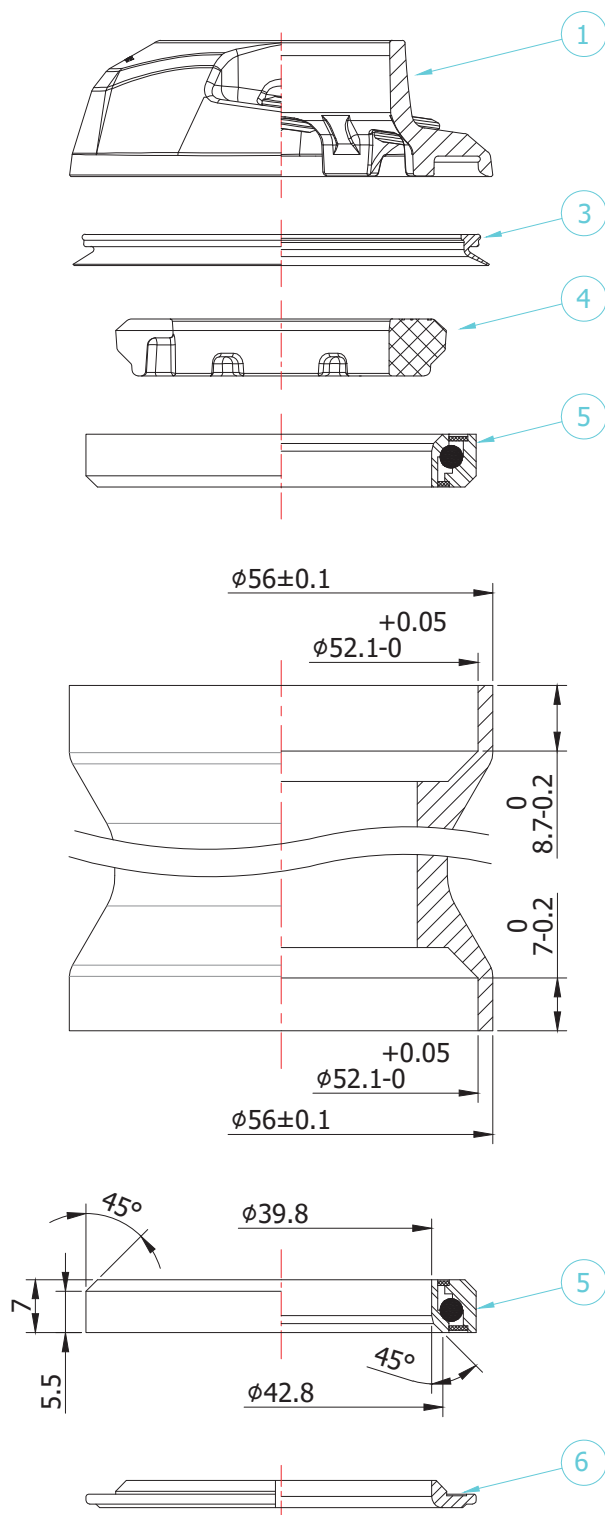
 S-Box Headset w/ Alloy Crown Race
 For $\phi 4\text{mm}$ Housing x2 + $\phi 5\text{mm}$ Brake Line x2

 Stack Height: $19 + 1 = 20\text{mm}$

SHIS code: IS52/28.6 | IS52/40

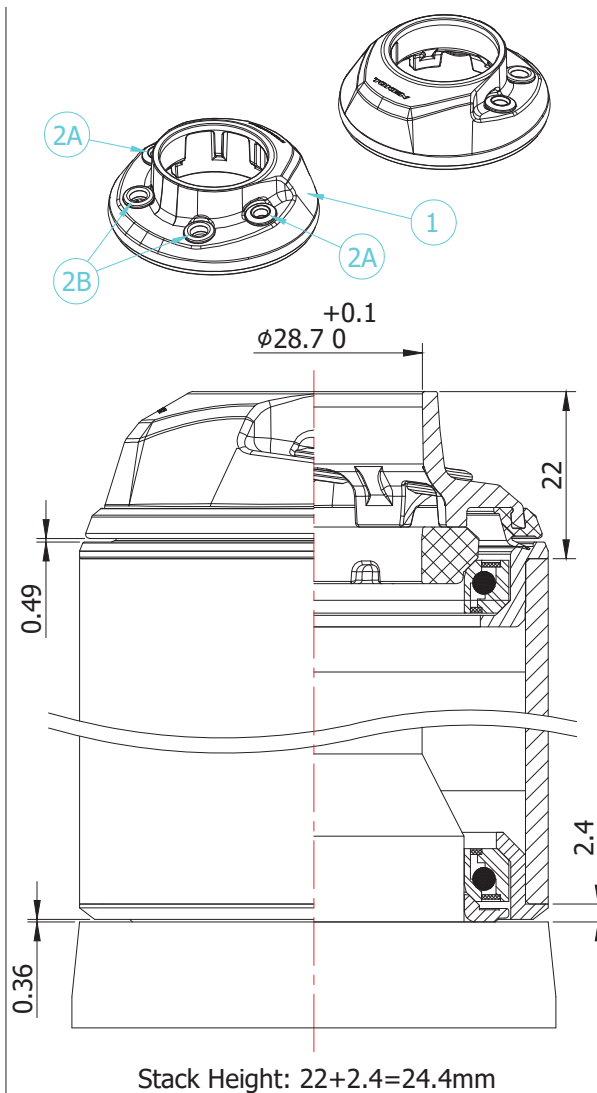
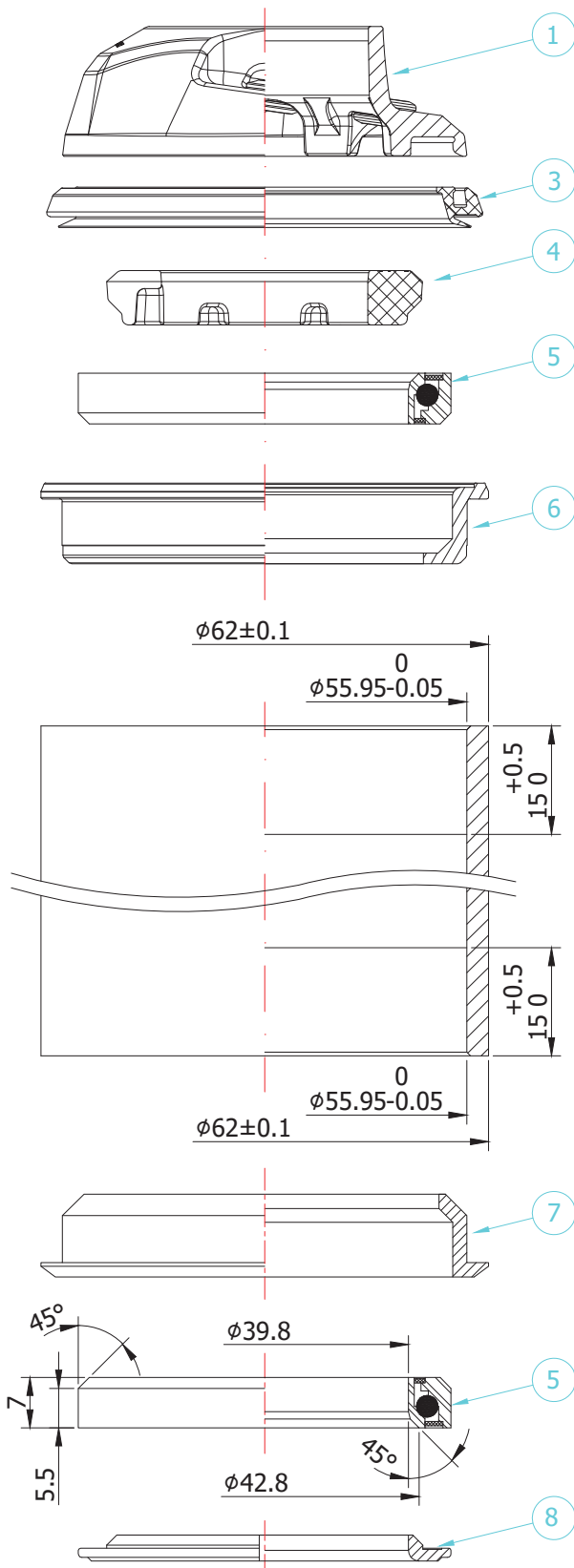
No.	Item	Material	Drawing	Q'ty
1	Top Cover	Composite	TK155SP-1	1
2A	Housing Seal 4mm	NBR	TK155SP-4	2
2B	Housing Seal 5mm	NBR	TK155SP-5	2
3	Top Cover Seal	NBR	TK155-1	1
4	Compression Ring	Composite	TK155-3	1
5	Sealed Bearing	Steel	ACB52H7/4	2
6	Crown Race	Alloy	TK1556-6	1
Unit: mm		Scale: 1:1		Revision: B
				2020.05.08

TK1566SP-CHHC
S-Box Headset w/ Alloy Cups and Alloy Crown Race
 For $\phi 4\text{mm}$ Housing x2 + $\phi 5\text{mm}$ Brake Line x2

SHIS code: ZS56/28.6 | ZS56/40

No.	Item	Material	Drawing	Q'ty
1	Top Cover	Composite	TK155SP-1	1
2A	Housing Seal 4mm	NBR	TK155SP-4	2
2B	Housing Seal 5mm	NBR	TK155SP-5	2
3	Top Cover Seal	NBR	TK156-1	1
4	Compression Ring	Composite	TK155-3	1
5	Sealed Bearing	Steel	ACB52H7/4	2
6	Upper Cup	Alloy	TK156-4-56	1
7	Lower Cup	Alloy	072-5	1
8	Crown Race	Alloy	TK1556-6	1

Unit: mm

Scale: 1:1

 Revision: B
 2020.05.08

TK1586SP
S-Box Headset

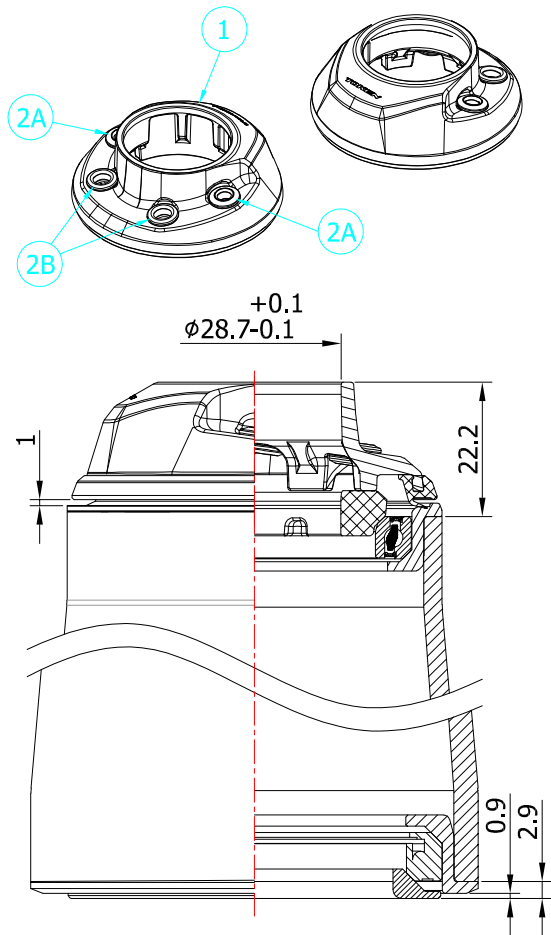
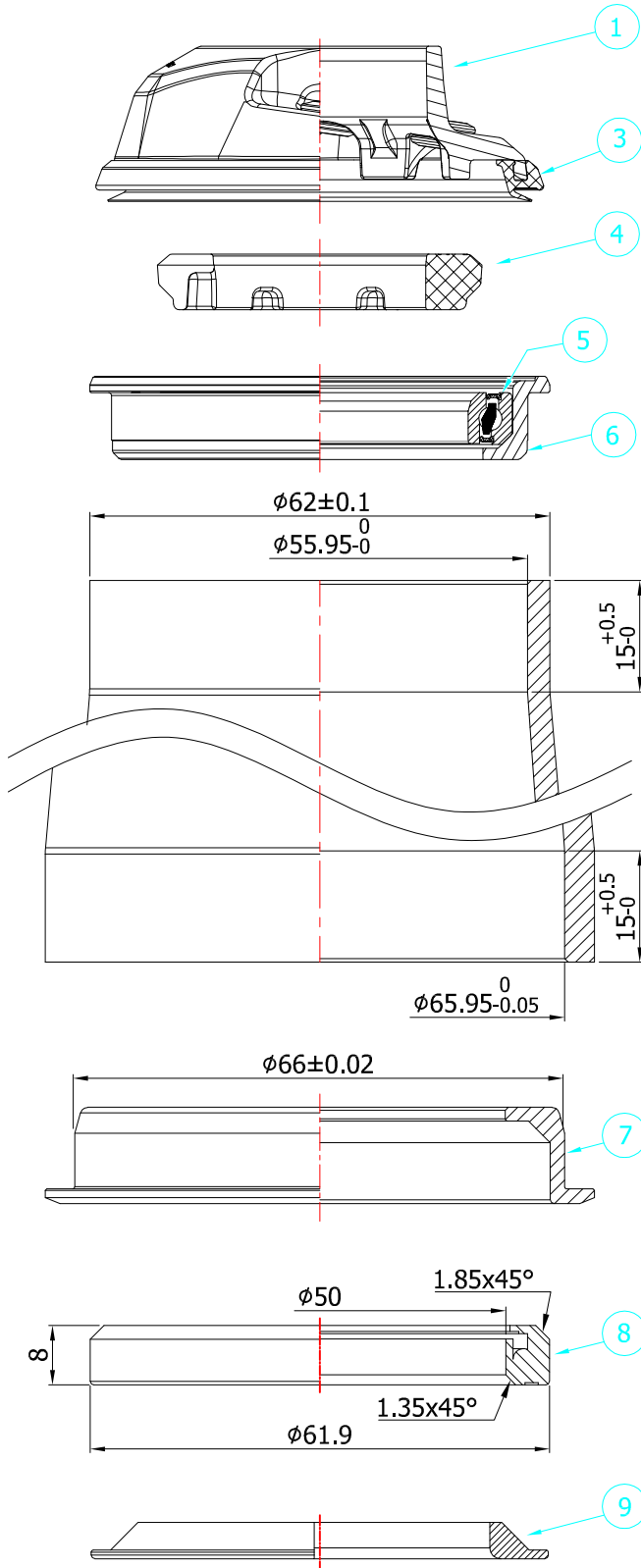
 For $\phi 4\text{mm}$ Housing x2 + $\phi 5\text{mm}$ Brake Line x2

SHIS code: ZS56/28.6 | ZS56/45.8

No.	Item	Material	Drawing	Q'ty
1	Top Cover	Composite	TK155SP-1	1
2A	Housing Seal 4mm	NBR	TK155SP-4	2
2B	Housing Seal 5mm	NBR	TK155SP-5	2
3	Top Cover Seal	NBR	TK156-1	1
4	Compression Ring	Composite	TK155-3	1
5	Premium Bearing	Steel	ACB52H7/4	1
6	Upper Cup	Alloy	TK156-4-56	1
7	Lower Cup	Alloy	TK188-5	1
8	Bearing	SUJ-2	ACB619	1
9	Crown Race	Alloy	TK188-6	1
Unit: mm		Scale: 1:1		Revision A
				2021.12.23

TK1536SP-CHHC

S-Box Headset / Proprietary Interface of HL Corp
For $\phi 4\text{mm}$ Housing x2 + $\phi 5\text{mm}$ Brake Line x2

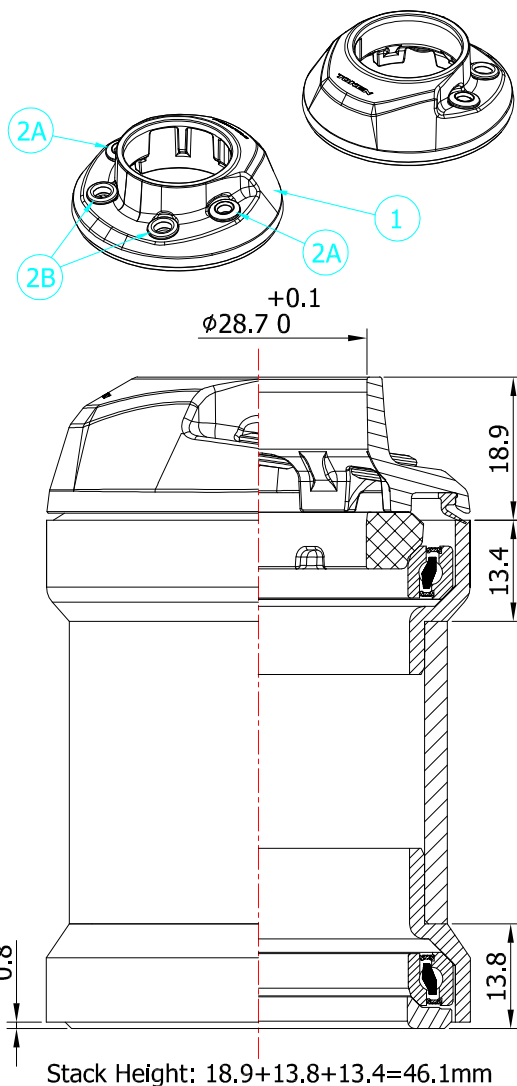
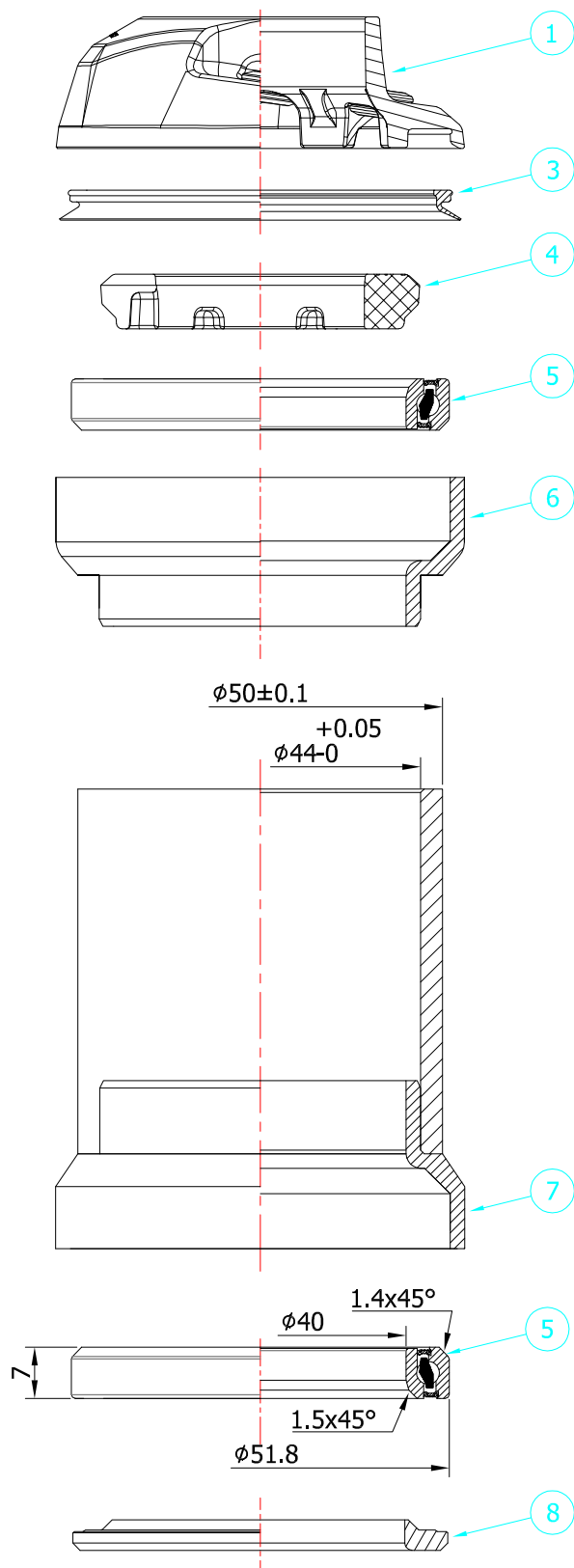

SHIS code: EC44/28.6 | EC44/40

No.	Item	Material	Drawing	Q'ty
1	Top Cover	Composite	TK155SP-1	1
2A	Housing Seal 4mm	NBR	TK155SP-4	2
2B	Housing Seal 5mm	NBR	TK155SP-5	2
3	Top Cover Seal	NBR	TK155-1	1
4	Compression Ring	Composite	TK155-3	1
5	Premium Bearing	Steel	ACB52H7/4	2
6	Upper External Cup	Alloy	TK1536-4	1
7	Lower External Cup	Alloy	036T-5	1
8	Crown Race	Alloy	072-6/2	1

Unit: mm

Scale: 1:1

Revision: A
2021.12.28

TK1536SPH-CHHC

S-Box Headset / Proprietary Interface of HL Corp
For $\phi 4\text{mm}$ Housing x2 + $\phi 5\text{mm}$ Brake Line x2

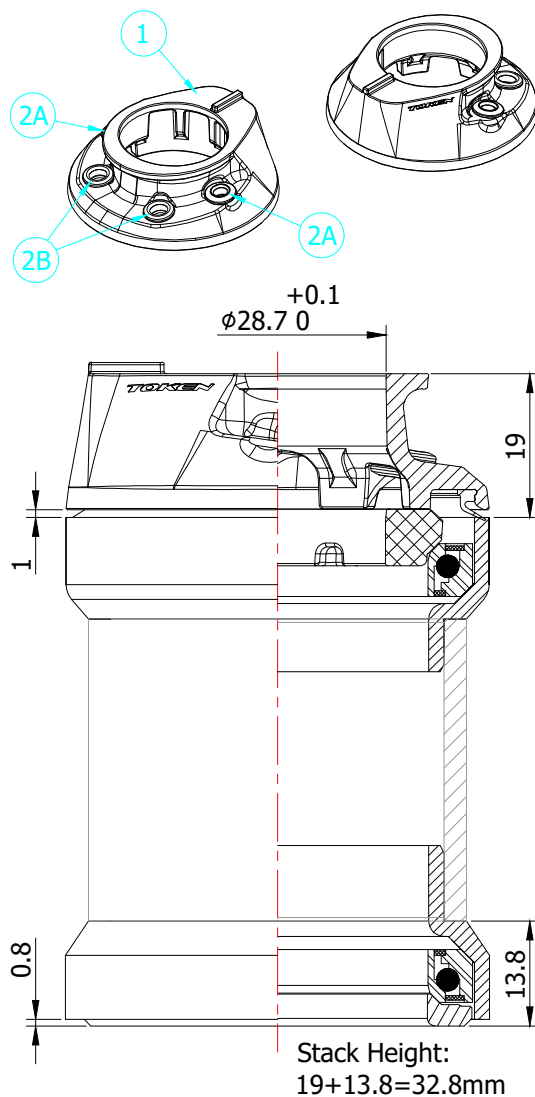
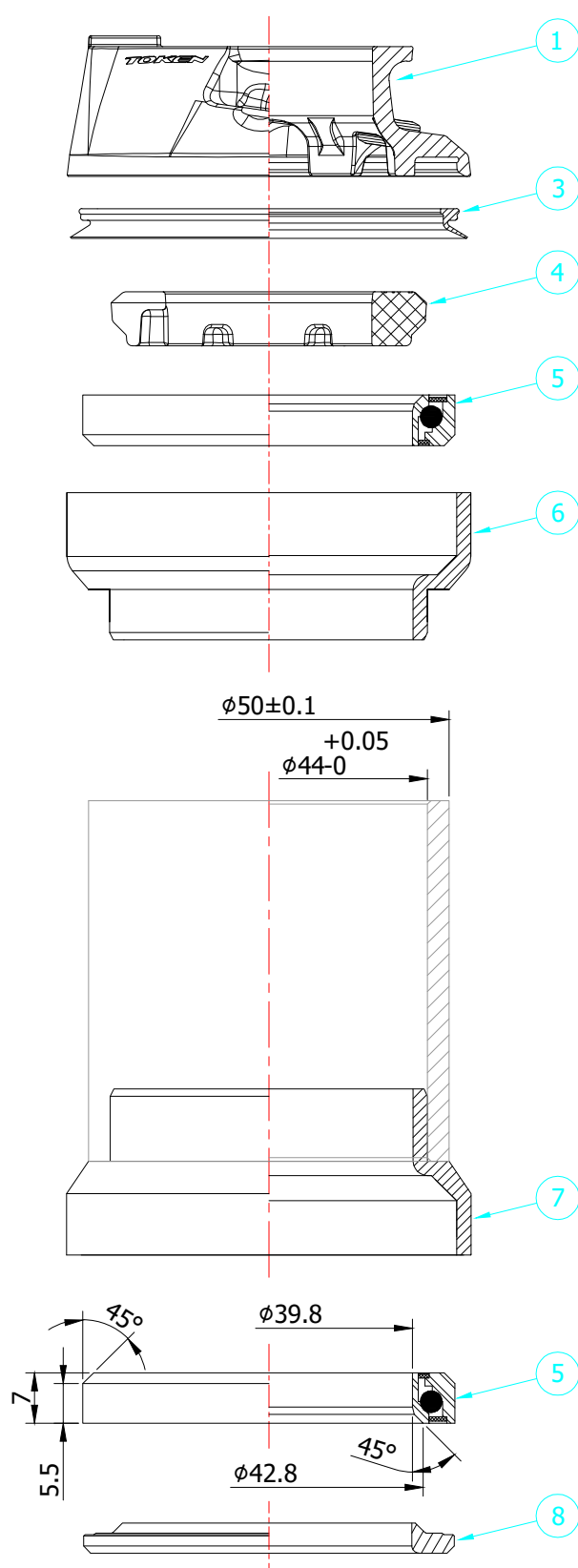

SHIS code: EC44/28.6 | EC44/40

No.	Item	Material	Drawing	Q'ty
1	Top Cover	Composite	TK155SPH-1	1
2A	Housing Seal 4mm	NBR	TK155SP-4	2
2B	Housing Seal 5mm	NBR	TK155SP-5	2
3	Top Cover Seal	NBR	TK155-1	1
4	Compression Ring	Composite	TK155-3	1
5	Sealed Bearing	Steel	ACB52H7/4	2
6	Upper External Cup	Alloy	TK1536-4	1
7	Lower External Cup	Alloy	036T-5	1
8	Crown Race	Alloy	072-6/2	1

Unit: mm

Scale: 1:1

Revision: A
2021.01.21

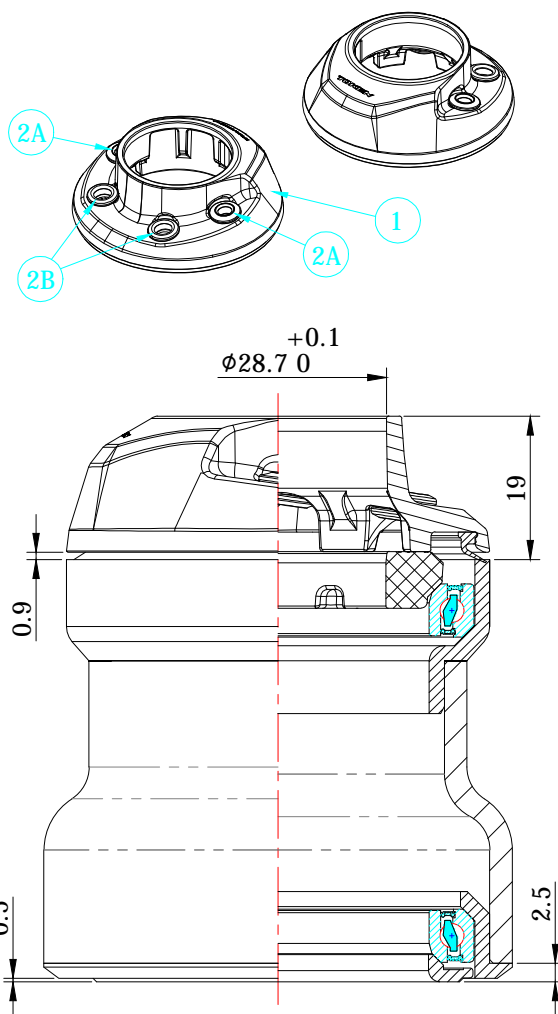
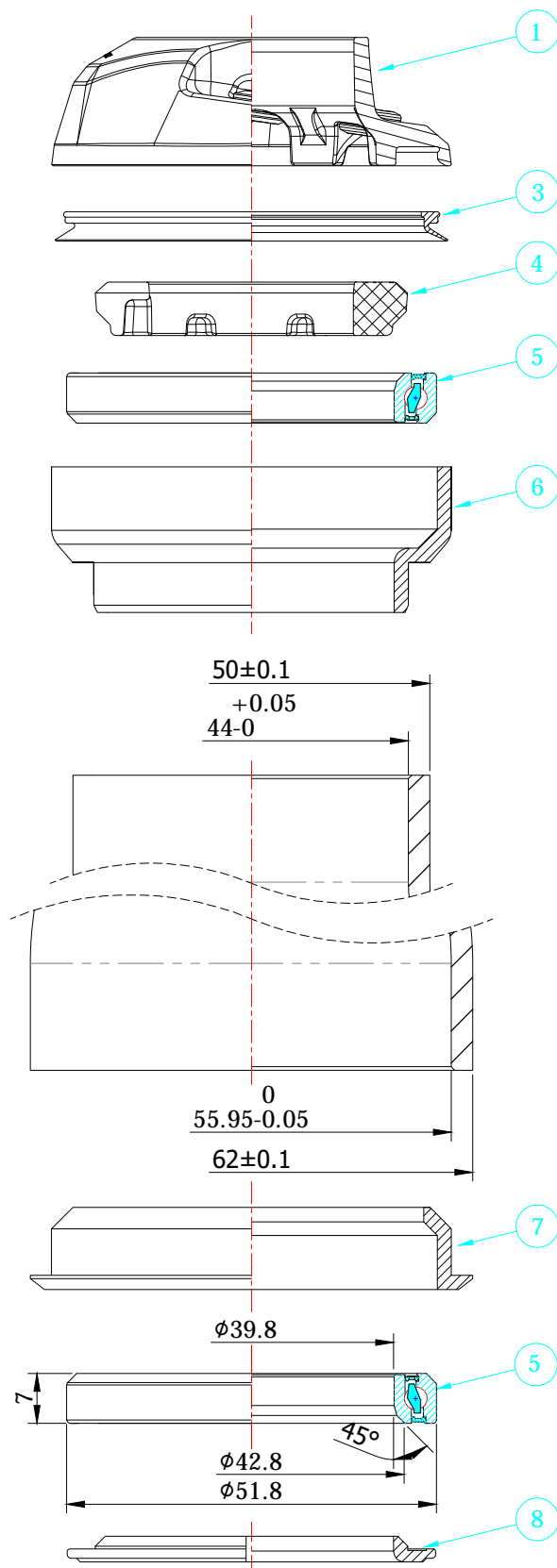
TK1537SP
S-Box Headset w/ Alloy Cups and Alloy Crown Race
 For $\phi 4\text{mm}$ Housing x2 + $\phi 5\text{mm}$ Brake Line x2

 Stack Height:
 $19 + 2.5 = 21.5\text{mm}$
SHIS code: EC44/28.6 | ZS56/40

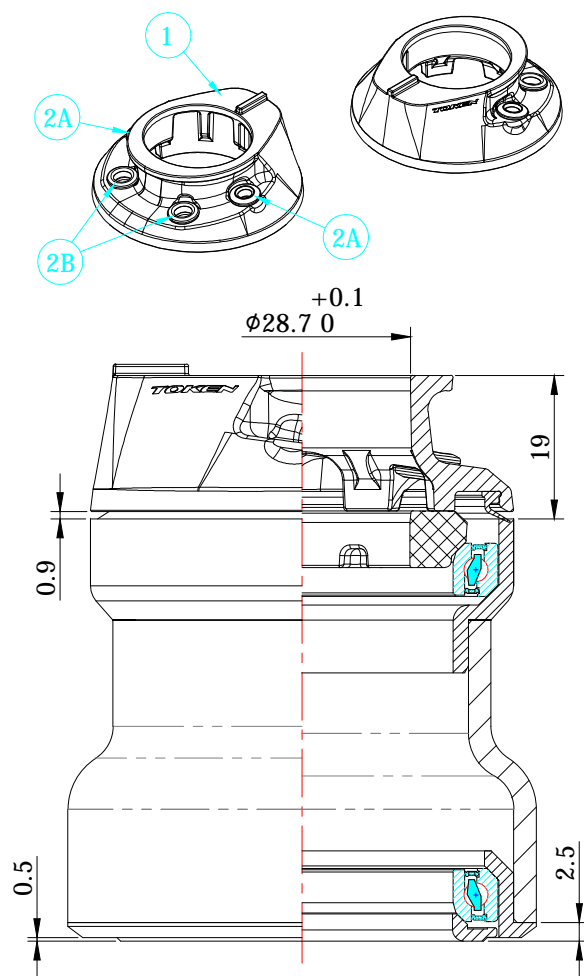
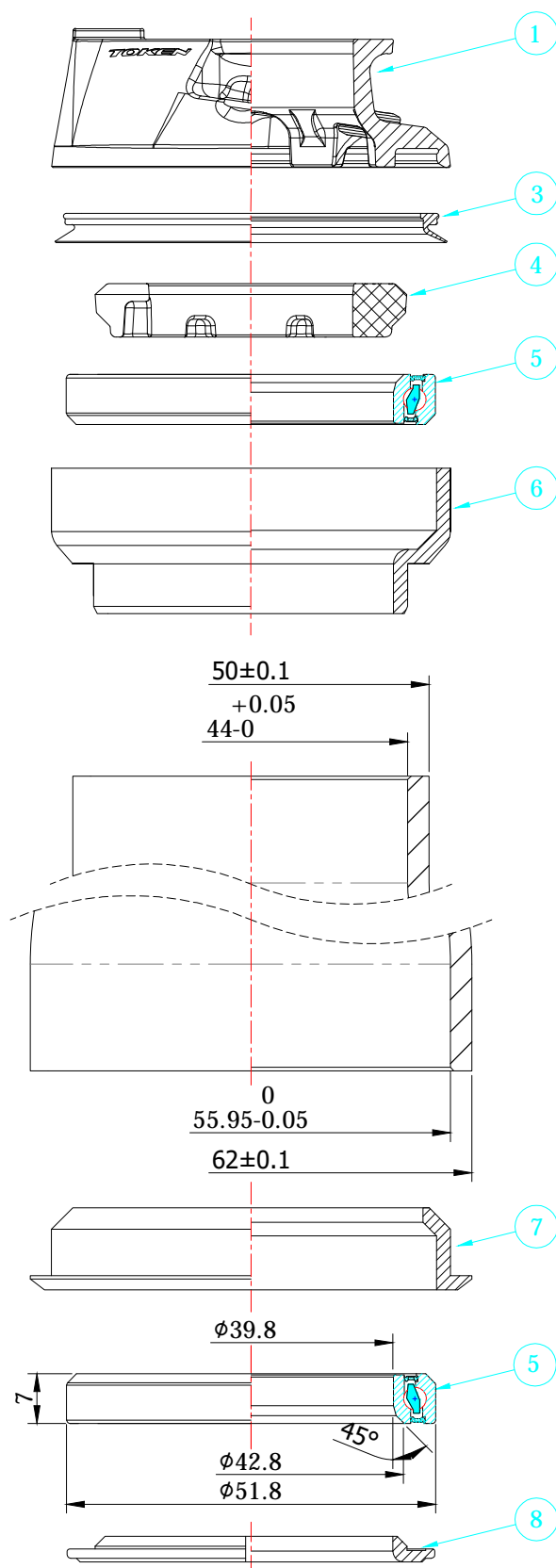
No.	Item	Material	Drawing	Q'ty
1	Top Cover	Composite	TK155SP-1	1
2A	Housing Seal 4mm	NBR	TK155SP-4	2
2B	Housing Seal 5mm	NBR	TK155SP-5	2
3	Top Cover Seal	NBR	TK155-1	1
4	Compression Ring	Composite	TK155-3	1
5	Premium Bearing	Steel	ACB52H7/4	2
6	Upper External Cup	Alloy	TK1536-4	1
7	Lower Cup	Alloy	072-5	1
8	Crown Race	Alloy	TK1556-6	1
Unit: mm		Scale: 1:1		Revision: A
				2021.11.22

TK1537SPH
S-Box Headset / Proprietary Interface of HL Corp
 For $\phi 4\text{mm}$ Housing x2 + $\phi 5\text{mm}$ Brake Line x2

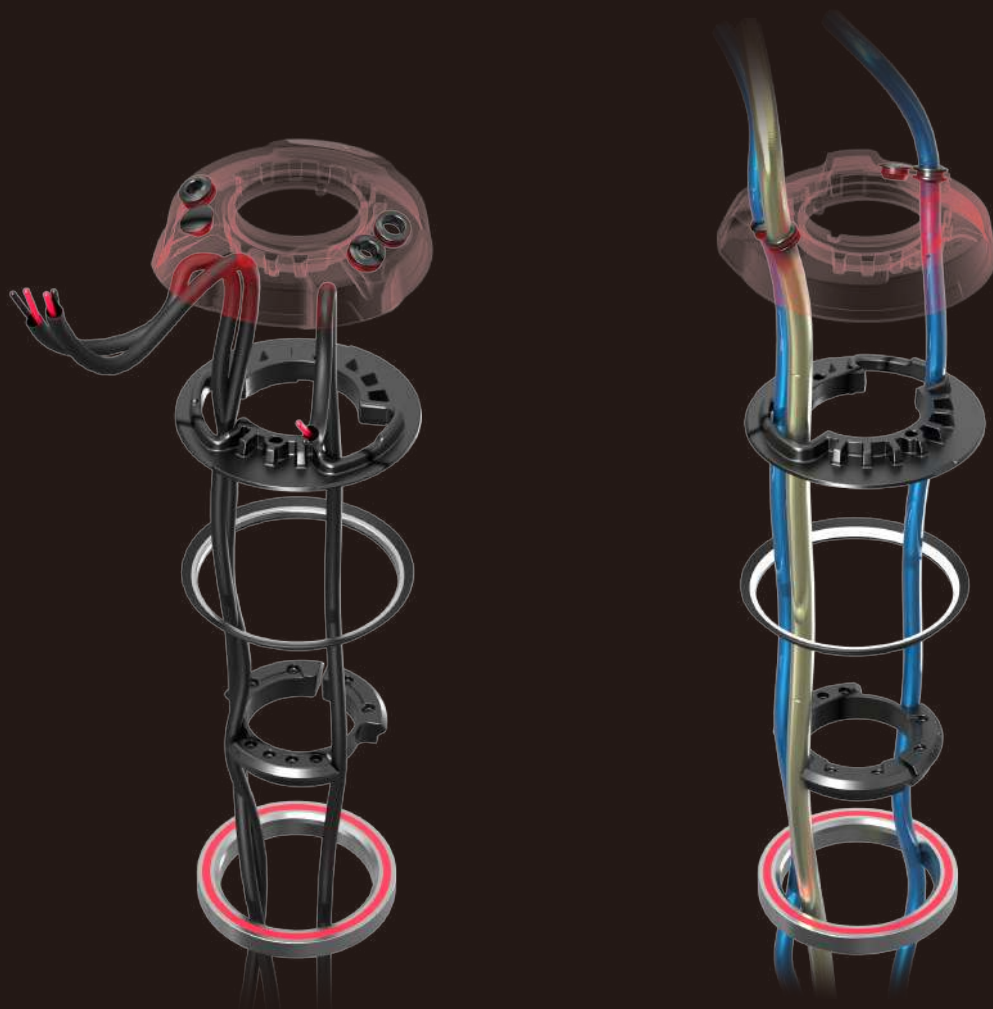
 Stack Height:
 $19 + 2.5 = 21.5\text{mm}$
SHIS code: EC44/28.6 | ZS56/40

No.	Item	Material	Drawing	Q'ty
1	Top Cover	Composite	TK155SPH-1	1
2A	Housing Seal 4mm	NBR	TK155SP-4	2
2B	Housing Seal 5mm	NBR	TK155SP-5	2
3	Top Cover Seal	NBR	TK155-1	1
4	Compression Ring	Composite	TK155-3	1
5	Sealed Bearing	Steel	ACB52H7/4	2
6	Upper External Cup	Alloy	TK1536-4	1
7	Lower Cup	Alloy	072-5	1
8	Crown Race	Alloy	TK1556-6	1
Unit: mm		Scale: 1:1		Revision: A
				2021.10.26



M-BOX NEW

Most secure solution for MTB & eMTB with up-to 6 Cables/ Wires.

Work with Electronic Cable w/Connector. (Patented)

Compatible with Standard Stem & Bar.

TK3566P-COHC

M-Box Headset w/ Semi-Integrated Alloy Cups & Crown Race
For $\phi 4$ Cable Housing *2 + $\phi 5$ Brake Line *1 plus Additional Wires

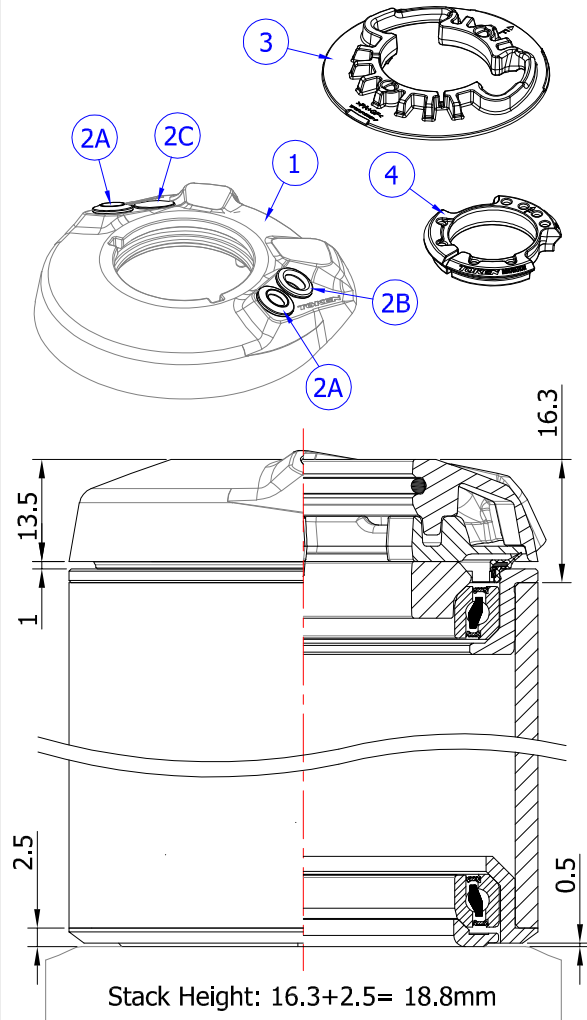
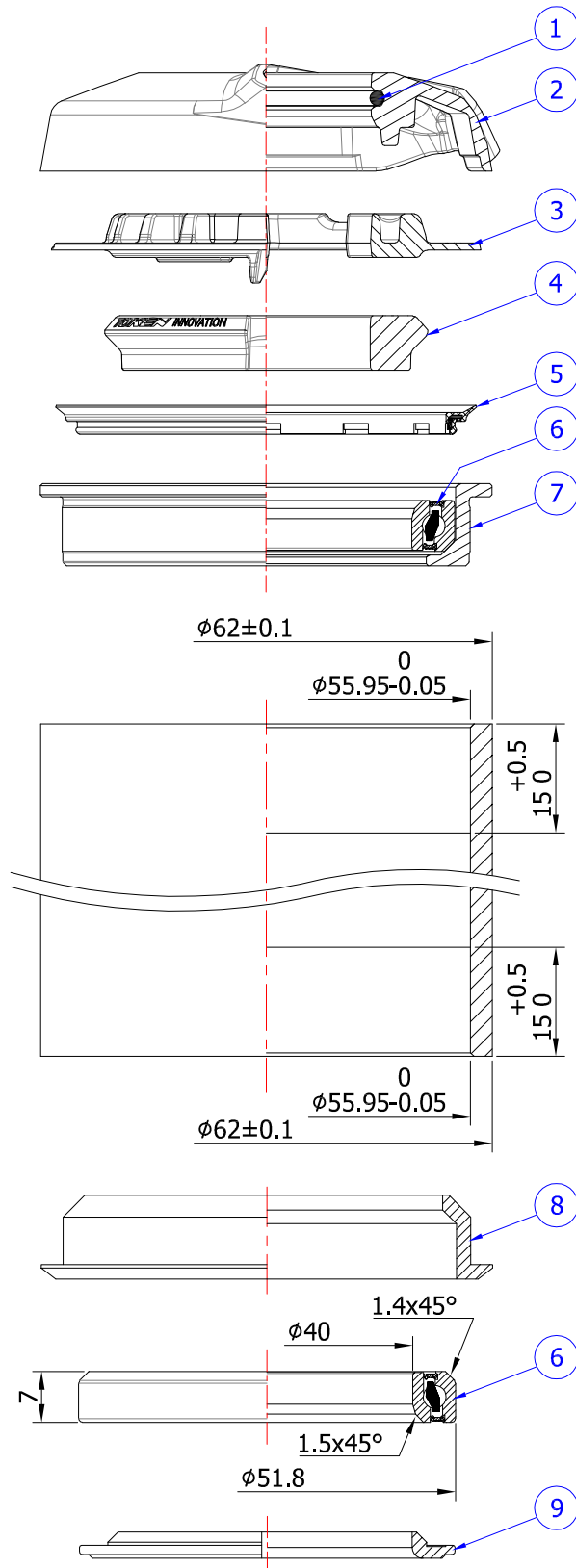

SHIS code: ZS56/28.6 | ZS56/40

No.	Item	Material	Drawing	Q'ty
1	O-ring	NBR	AS024	1
2	Composite Top Cover	Composite	TK355-1	1
2A	Housing Grommet 4mm	NBR	TK155SP-4	1
2B	Housing Grommet 5mm	NBR	TK155SP-5	2
2C	Port Plug	NBR	TK155SP-6	1
3	Separator	Composite	TK355-2	1
4	Compression Ring	Composite	TK155M-3	1
5	Seal	SPCC+NBR	TK355-4	1
6	Premium Bearing	Steel	ACB52H7/4	2
7	Upper Cup	Alu-alloy	TK1566M-4-56	1
8	Lower Cup	Alu-alloy	072-5	1
9	Crown Race	Alu-alloy	TK1556-6	1
Unit: mm		Scale: 1:1		Revision: C 2022.10.17

www.tokenproducts.com

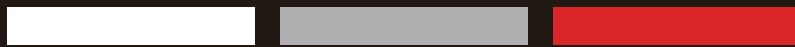

service@tokenproducts.com